



Satellite Sewer Systems





Satellite Sewer Systems



- Regulation 61-9.610
- “Satellite sewer system”
 - Wastewater system that is owned or operated by one person that discharges to a system that is owned or operated by a different person.
 - Satellite sewer systems depend on a separate person for final wastewater treatment and discharge ...



Satellite Sewer Systems

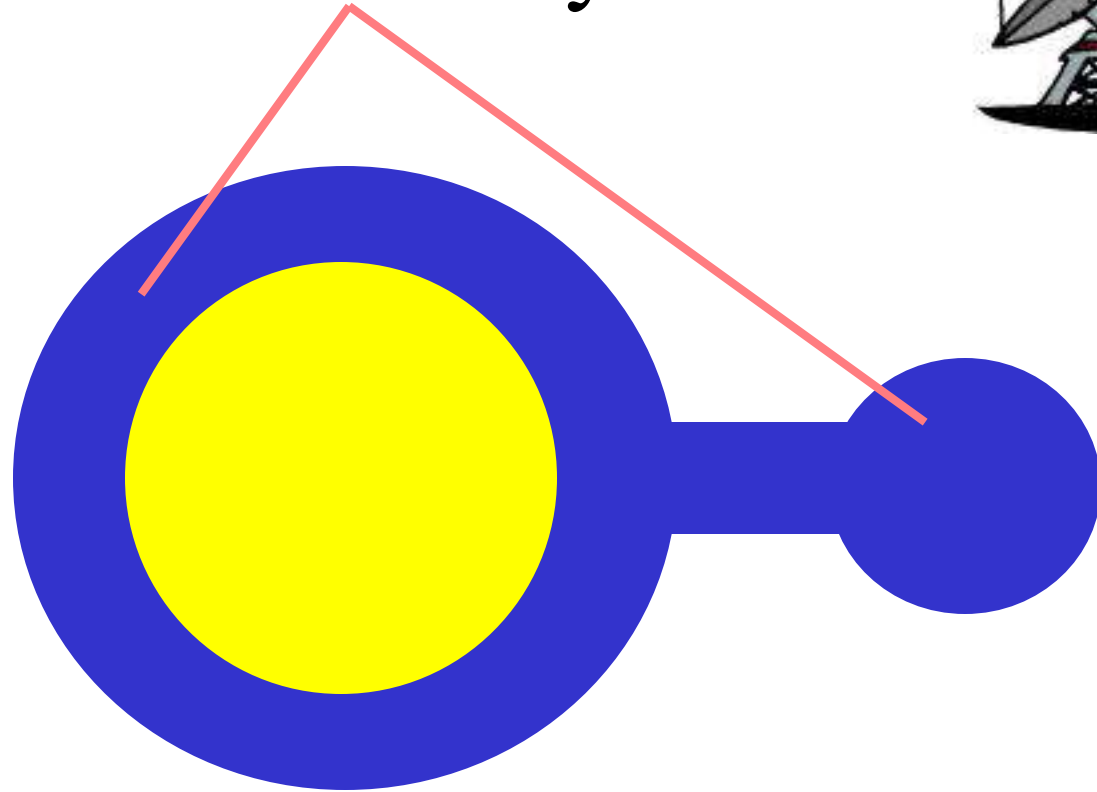



Satellite Sewer Systems



Homes



Satellite Sewer Systems

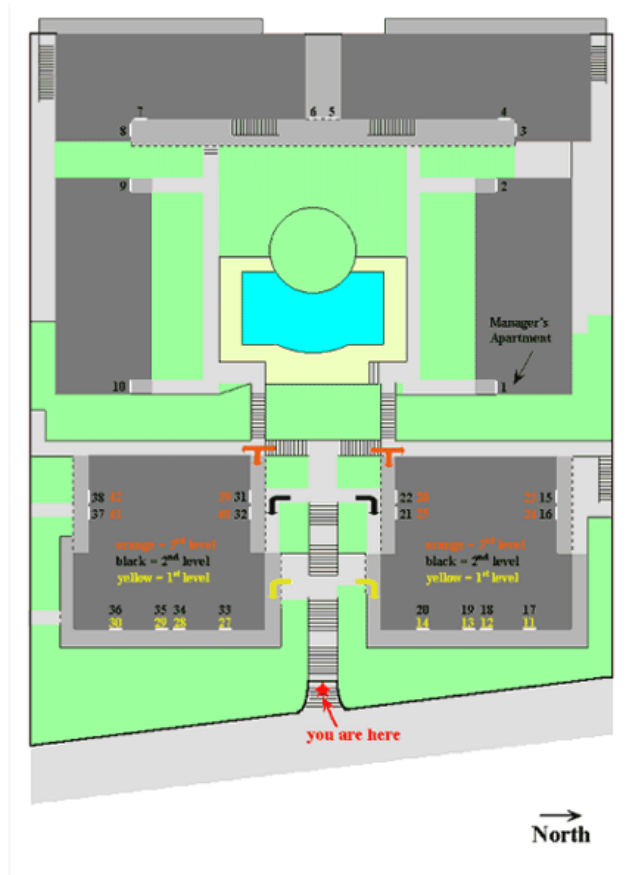

Apartments



Satellite Sewer Systems



Industries



Satellite Sewer Systems

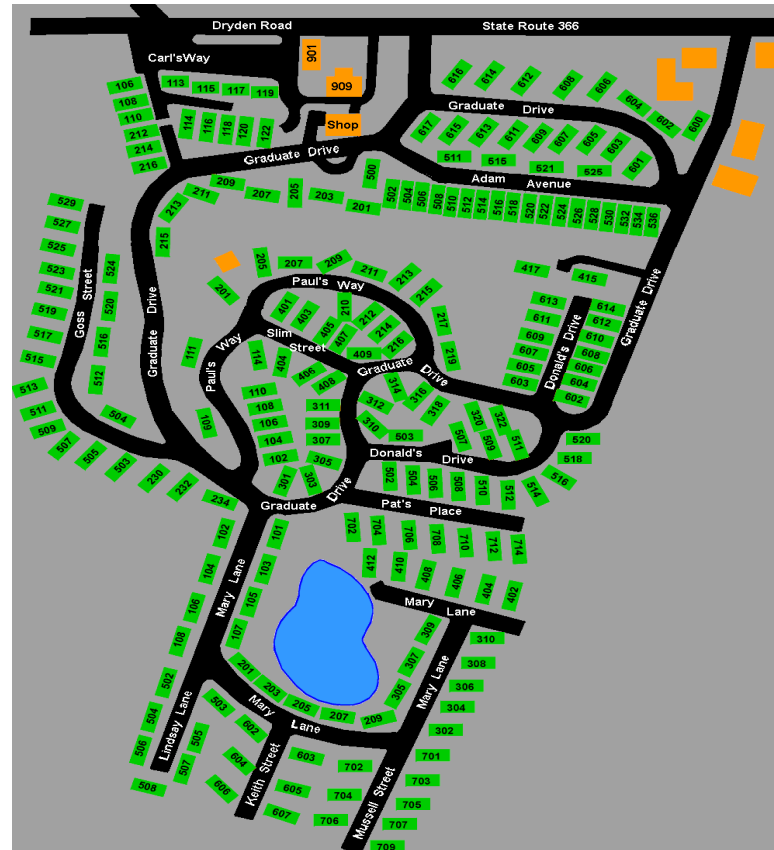

Mobile Home Parks



Satellite Sewer Systems



Cities, Sub-districts



Satellite Rule Purpose



- NPDES/ND permits require
 - Proper O&M
 - Reporting of releases/overflows/bypasses
- Satellite systems: prior regulation was construction only
- Develop inventory
- Track ownership transfers



Satellite Systems *Covered*



- No NPDES/ND (i.e., rely on others for final treatment/disposal)
- Facilities are subject to a DHEC construction permit [i.e., those who received a permit or would need one under R.61-67)]
- Who affected? (think customers of POTWs)
 - Industries, apartments, sewer subdistricts, etc.



Industries Affected?



- Pretreatment facilities



- Other systems needing a permit (e.g., force main to force main connection).



Satellite Rule



- Addresses O&M and permitting
- Permitting via general operating permit
- Permit effective when DHEC notifies individual systems
- Regulation applies regardless of permit coverage



Scope of R.61-9.610



(a) *Properly manage, operate, and maintain* at all times all parts of its sewer system(s), to include maintaining contractual operation agreements to provide services, if appropriate;

(b) *Provide adequate capacity* to convey base flows and peak flows for all parts of the sewer system or, if capital improvements are necessary to meet this standard, develop a schedule of short and long term improvements;

(c) Take all *reasonable steps to stop and mitigate* the impact of releases of wastewater to the environment; and

(d) *Notify the Department* within 30 days of a proposed change in *ownership* of a sewer system.



Satellite Permit

OPERATING PERMIT

Satellite Sewer System Operation & Maintenance Requirements

PERMIT #: SSS000000

This operating permit is a general permit and sets requirements for Satellite Sewer Systems under the provisions of R.61-9.610. Coverage under this permit is set by the S.C. Dept. of Health and Environmental Control (DHEC) under R.61-9.610.6(a) for satellite system owners. Exemptions from coverage include components of a satellite system serving a single family dwelling, or a duplex dwelling, or dwellings of the same family on one piece of property. See definitions in R.61-9.

Satellite sewer system means a sewer system that is owned or operated by one person that discharges to a system that is owned or operated by a different person. Satellite sewer systems depend on a separate person for final wastewater treatment and discharge and include systems approved under R.61-9.505.8.

Nothing in this permit supersedes a more stringent requirement that may be imposed by sewer system owners that manage wastewater from satellite systems. This permit does not authorize any discharge from a sewer system to the environment. Such discharges are a violation of the Pollution Control Act (S.C. Code § 48-1-90(a)(2008)). This permit is effective for an owner upon notification by DHEC until a separate notification is provided of permit coverage being revoked, modified or reissued. Owners that already have coverage under the prior permit do not need to notify DHEC. Owner coverage shifts to this permit automatically.

Any noncompliance with the terms, conditions or requirements of this permit constitutes a violation of the Pollution Control Act and is grounds for enforcement action.

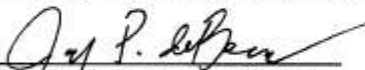
Jeffrey P. deBessonet, P.E., Director
Water Facilities Permitting Division



Issued: January 4, 2012
Expiration: January 4, 2017

I. GENERAL REQUIREMENTS

The requirements to properly operate and maintain satellite sewer systems are the responsibility of the system owner as follows:

- (a) Properly manage, operate, and maintain in good working order at all times all parts of its sewer system(s)



Scope of Permit



- Implement a O&M plan ...
- Inventory of spare parts ...
- Maintain a contact number
- Keep records
- Provide DHEC info as needed
- Notify of transfer
- Report overflows
- Complete a form (basic info about system)



PERMIT: Report overflows that ...



- Reach waters of the state
- Pose a threat to human health/environment
- Exceed 500 gallons (on land)

- *Other notes:*

- Notify orally within 24 hours
- In writing within 5 days
- On Form 3685

Notification thresholds same as what is expected for NPDES permittees.



Impact of Program



- Requirements include:
 - Notification
 - Proper O&M
 - Provide needed capacity in systems
 - Have 24-hour number available
 - Report system releases to environment
 - DHEC approval of permit transfers



Satellite Questions?



- Bridget Clarke
- 803-898-4239
- clarkebm@dhec.sc.gov