

**SCDHEC OFFICE OF OCEAN AND COASTAL RESOURCE MANAGEMENT
PERMIT APPLICATION PUBLIC NOTICE**

April 10, 2009

Permit Number: OCRM-09-032-D
Permit ID: 66491

The SCDHEC Office of Ocean and Coastal Resource Management has received an application for a permit for the alteration of a critical area. This application was submitted pursuant to the Coastal Zone Management Act (Act 123) of the 1977 South Carolina General Assembly. The application, in brief, is described as follows:

APPLICANT: Anne B Arial
C/O George A Z Johnson Jr. Inc.
6171 Savannah Hwy
Ravenel, S.C. 29470

LOCATION: On and adjacent to tributary of Schooner Creek at 1163 Cottage Raod, Charleston, Charleston County, South Carolina. TMS#: 428-01-00-084.

WORK: The work as proposed and shown on the attached plans consists of constructing a dock. Specifically, the applicant seeks to construct a 4' x 140' walkway leading to a covered 15' x 15' fixed pierhead. Channelward of the pierhead, a 3' x 20' ramp will access a 10' x 20' floating dock. In addition, a covered 12.5' x 12.5', four-pile boatlift and 3' catwalk is proposed floodside of the pierhead. The work as described is for the applicant's private, recreational use.

This public notice is being distributed to all known interested persons and agencies to assist in developing facts on which a decision by OCRM can be based. Comments concerning the proposed work should be submitted in writing, setting forth sufficient detail to furnish a clear understanding of the reasons for support or opposition.

The decision to issue or deny a permit will be based on the individual merits of the application, the policies specified in the South Carolina Coastal Zone Management Act, and the considerations outlined in the State of South Carolina Coastal Zone Management Program. Interested parties who wish to be notified of final permit action must notify OCRM in writing of this request.

To assure review by OCRM, comments regarding this application must be received by OCRM on or before April 25, 2009. For further information please contact the project manager for this activity, Jeff Thompson at 843-953-0219.

PLEASE REPLY TO:

SCDHEC OFFICE OF OCEAN AND COASTAL RESOURCE MANAGEMENT
1362 McMillan Avenue, Suite 400
Charleston, South Carolina 29405

Please refer to P/N# OCRM-09-032-D



Tess Rodgers, Wetland Section Coordinator

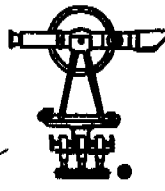

GEORGE A.Z. JOHNSON, JR., INC.
LAND SURVEYORS

6171 Savannah Highway
 Ravenel, South Carolina 29470
 (843) 689-1492 Charleston No. 722-3692 Edisto No. 689-1495

Critical Line Certified by Josh Young on 9/12/08 on a Plat by GAZJ, Inc. Dated 9/08/08.

Property of
Robert A. Campbell
 P.M.S.
 428-01-00-084

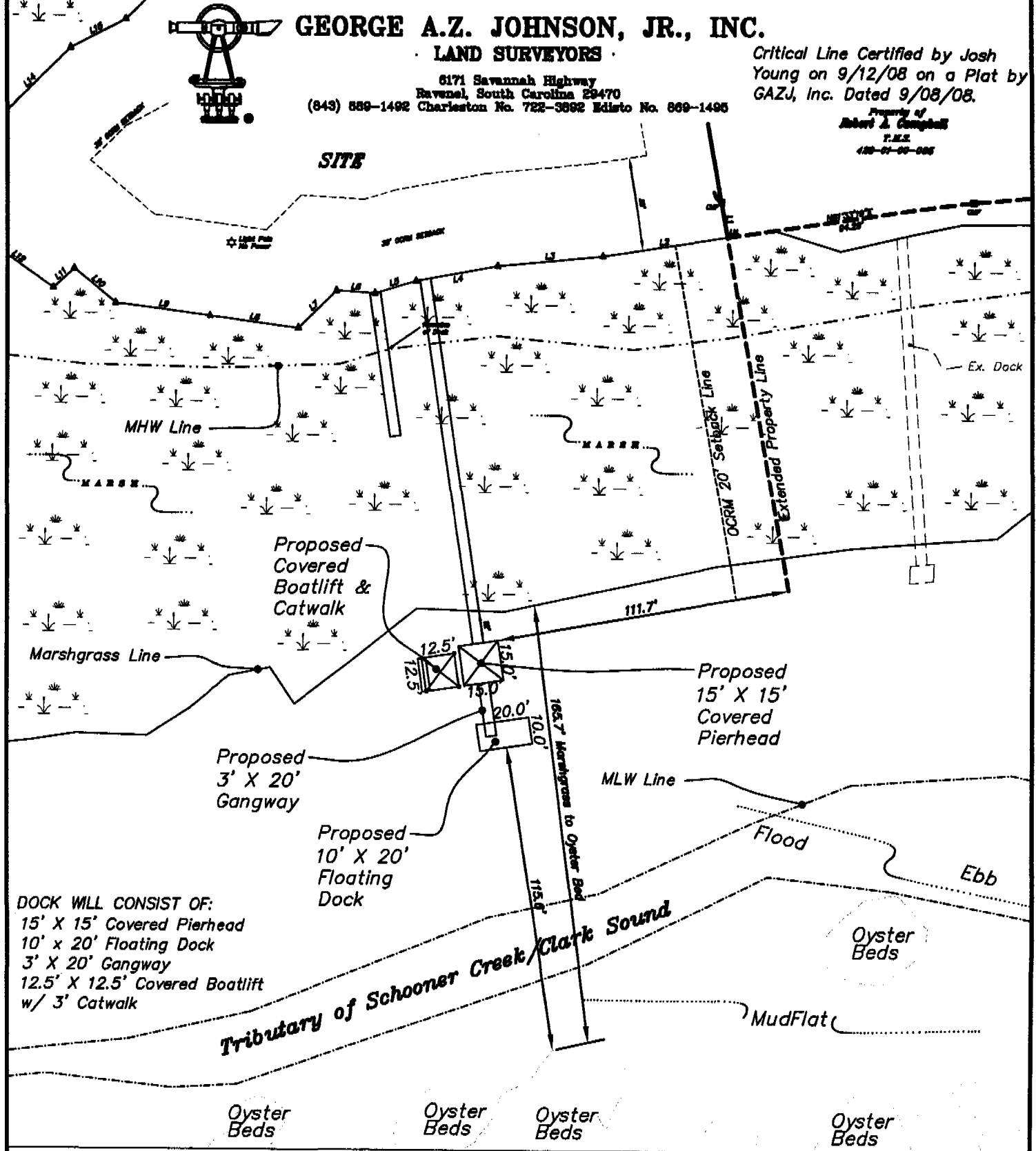

DOCK WILL CONSIST OF:
 15' X 15' Covered Pierhead
 10' x 20' Floating Dock
 3' X 20' Gangway
 12.5' X 12.5' Covered Boatlift
 w/ 3' Catwalk

Applicant: Anne B. Ariail
 1163 Cottage Road
 James Island, SC 29412
 Charleston County
 TMS No. 428-01-00-084
 Tributary of Schooner Creek/Clark Sound
 GAZJ JOB # 22837

DETAIL PLAN
 PRIVATE
 RECREATIONAL DOCK
 FOR TMS 428-01-00-084
 DATE: FEB. 20, 2009
 SCALE 1" = 50'

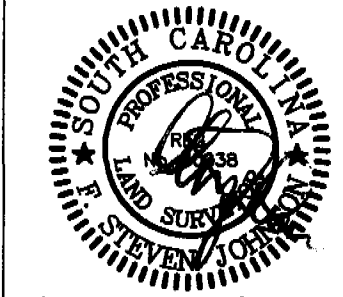

P/N#

OCRM-09-032-D

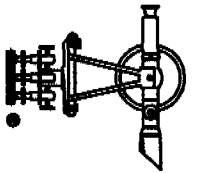

GEORGE A.Z. JOHNSON, JR., INC.

LAND SURVEYORS

6171 Savannah Highway
Ravenna, South Carolina 29410
(843) 886-1482 Charleston No. 722-3692 Edisto No. 869-1485

Critical Line Certified by Josh
Young on 9/12/08 on a Plat by
GAZJ, Inc. Dated 9/08/08.

- DOCK WILL CONSIST OF:
- 15' X 20' Fixed Pierhead w/
- 17' X 35' Roof
- 10' X 40' Floating Dock
- 3' X 20' Gangway
- 12.5' X 12.5' Boatlift w/ 3'
- Gatwalk
- Two Mooring Piles

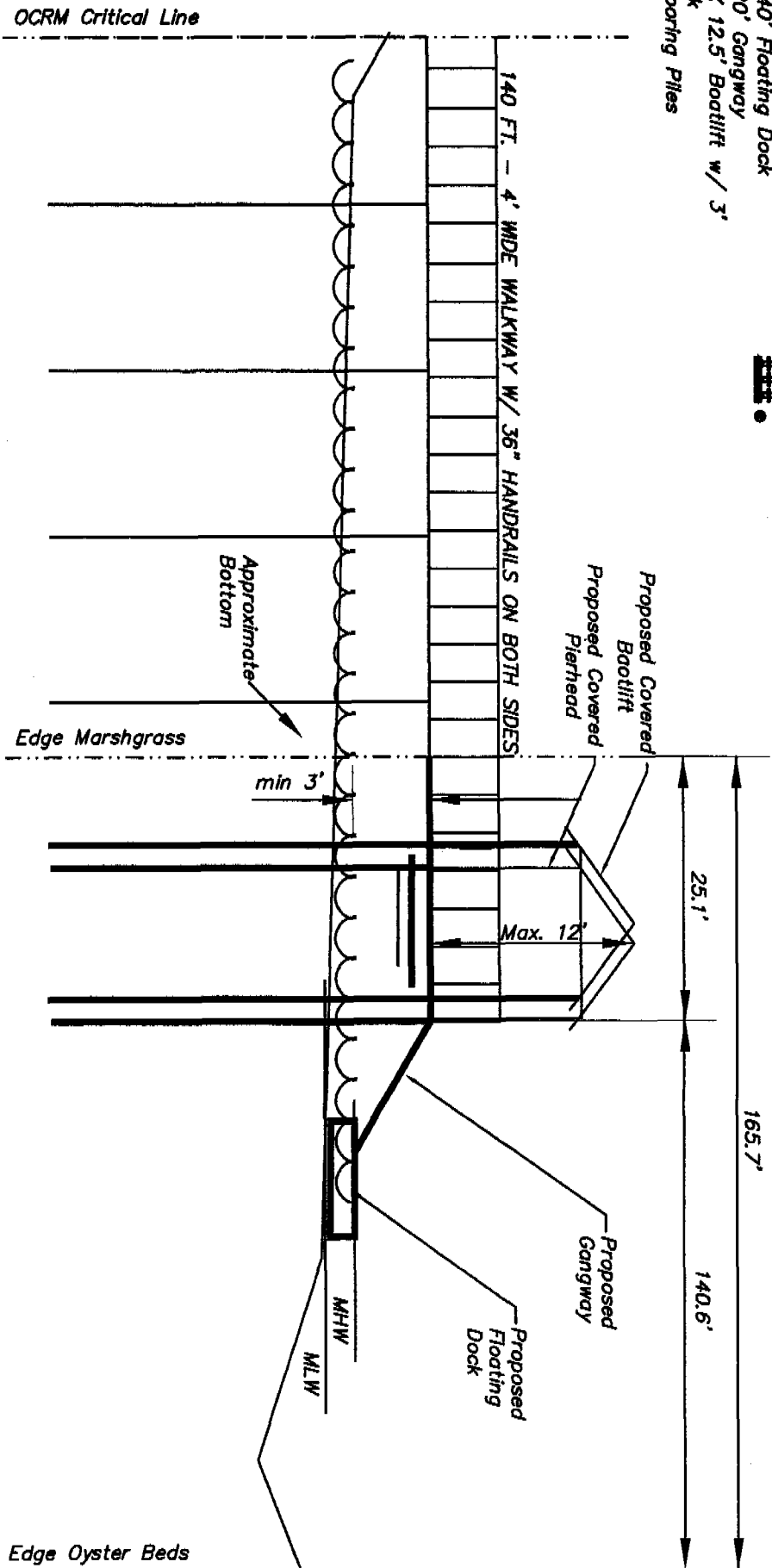

OCRM-09-032-D

Applicant: Anne B. Artail
 1163 Cottage Road
 James Island, SC 29412
 Charleston County
 TMS No. 428-01-00-084
 Tributary of Schooner Creek/Clark Sound
 GAZJ JOB # 22837

P/N#

SIDE VIEW

PRIVATE
 RECREATIONAL DOCK
 FOR TMS 428-01-00-084
 DATE: FEB. 20, 2009
 SCALE "NTS"

Sheet 4 of 4



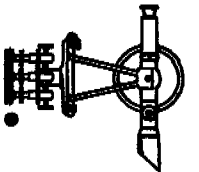

GEORGE A.Z. JOHNSON, JR., INC.

LAND SURVEYORS

6171 Savannah Highway
Havensol, South Carolina 29470
(843) 888-1492 Charleston No. 722-3892 Estero No. 888-1495

Critical Line Certified by Josh
Young on 9/12/08 on a Plat by
GAZJ, Inc. Dated 9/08/08.

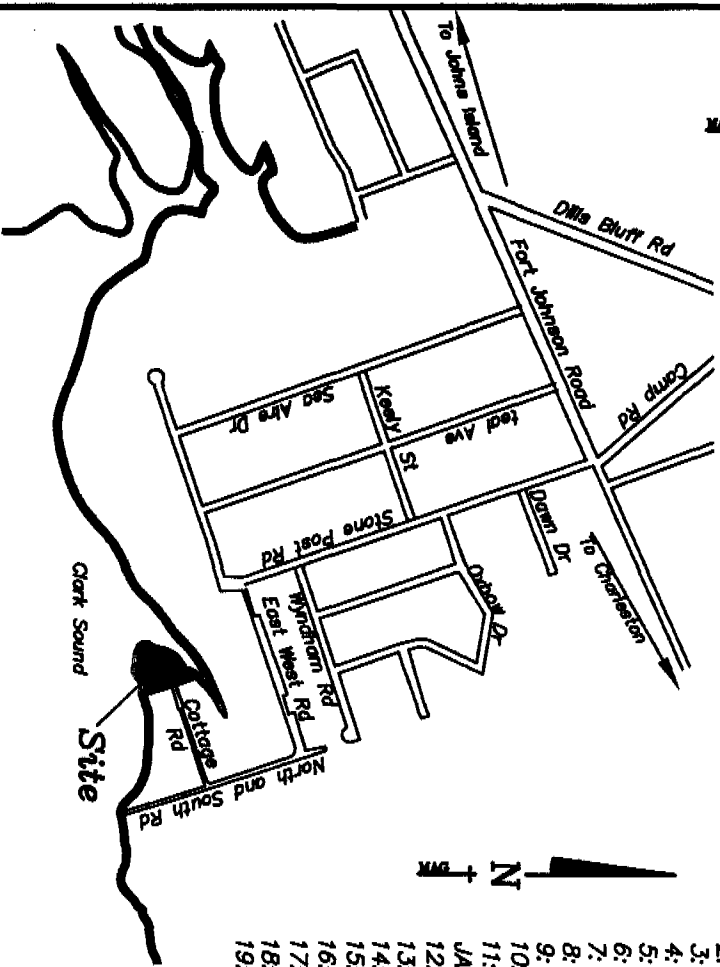

- 1: Start out going WEST on MCMILLAN AVE/3RD ST toward NOISSETTE BLVD.
- 2: Turn LEFT onto AVENUE E S. 0.1 mi
- 3: Turn RIGHT onto COSGROVE AVE EXT. 0.2 mi
- 4: COSGROVE AVE EXT becomes COSGROVE AVE. 1.1 mi
- 5: COSGROVE AVE becomes SC-7. 0.2 mi
- 6: Merge onto I-26 E toward CHARLESTON. 4.4 mi
- 7: Merge onto US-17 S via EXIT 221A toward SAVANNAH. 1.2 mi
- 8: Turn SLIGHT RIGHT onto SPRING ST. 0.2 mi
- 9: Turn LEFT onto LOCKWOOD BLVD. 0.1 mi
- 10: LOCKWOOD BLVD becomes LOCKWOOD DR. 0.0 mi
- 11: Merge onto SC-30 W/JAMES ISLAND EXPY via the ramp on the LEFT toward JAMES ISLAND/FOLLY BEACH. 2.6 mi
- 12: Take the SC-171/FOLLY ROAD exit, EXIT 3, toward FOLLY BEACH. 0.2 mi
- 13: Merge onto FOLLY RD/SC-171 toward JAMES ISLAND/FOLLY BEACH. 1.2 mi
- 14: Turn LEFT onto CAMP RD. 1.5 mi
- 15: CAMP RD becomes STONE POST RD. 0.4 mi
- 16: Turn LEFT onto EAST AND WEST RD (Portions unpaved). 0.2 mi
- 17: EAST AND WEST RD becomes NORTH AND SOUTH RD (Portions unpaved). 0.1 mi
- 18: Turn RIGHT onto COTTAGE RD (Portions unpaved). 0.1 mi
- 19: End at 1163 Cottage Rd Charleston, SC 29412-9402

DOCK WILL CONSIST OF:
15' X 15' Covered Plathead
10' x 20' Floating Dock
3' X 20' Gangway
12.5' X 12.5' Covered Boatlift
w/ 3' Catwalk

Location Map "NTS"

Applicant: Anne B. Ariail
1163 Cottage Road
James Island, SC 29412
Charleston County
TMS No. 428-01-00-084
Tributary of Schooner Creek/Clark Sound
GAZJ JOB # 22837

P/N#

LOCATION MAP

PRIVATE
RECREATIONAL DOCK
FOR TMS 428-01-00-084
DATE: FEB. 20, 2009
SCALE "NTS"

Sheet 1 of 4

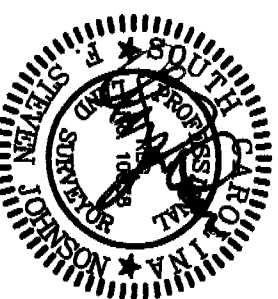

OCRM-09-032-D