

**SCDHEC OFFICE OF OCEAN AND COASTAL RESOURCE MANAGEMENT  
PERMIT APPLICATION PUBLIC NOTICE**

**April 10, 2009**

**Permit Number:** OCRM-08-229-E  
**Permit ID:** 64776

The SCDHEC Office of Ocean and Coastal Resource Management has received an application for a permit for the alteration of a critical area. This application was submitted pursuant to the Coastal Zone Management Act (Act 123) of the 1977 South Carolina General Assembly. The application, in brief, is described as follows:

**APPLICANT:** Robert Chipley  
C/O George A. Z. Johnson, Jr., Inc.  
6171 Savannah Hwy.  
Ravenel, SC 29470

**LOCATION:** On and adjacent to the Stono River at 5031 Trexler Ave., Hollywood, Charleston County, South Carolina. TMS#: 248-00-00-011.

**WORK:** The work as proposed and shown on the attached plans consists of rebuilding an existing dock, consisting of a 6' x 68' walkway with handrails, a 17' x 20' covered fixed pierhead, a 10' x 20' floating dock with 3' x 20' ramp, and a 10' x 20' boatlift with a 3' wide catwalk. The work as described for the applicant's private recreational use. Please Note: the application drawings also show a 270' timber bulkhead to be constructed landward of the critical area line.

This public notice is being distributed to all known interested persons and agencies to assist in developing facts on which a decision by OCRM can be based. Comments concerning the proposed work should be submitted in writing, setting forth sufficient detail to furnish a clear understanding of the reasons for support or opposition.

The decision to issue or deny a permit will be based on the individual merits of the application, the policies specified in the South Carolina Coastal Zone Management Act, and the considerations outlined in the State of South Carolina Coastal Zone Management Program. Interested parties who wish to be notified of final permit action must notify OCRM in writing of this request.

*To assure review by OCRM, comments regarding this application must be received by OCRM on or before April 25, 2009. For further information please contact the project manager for this activity, Bill Eiser, at 843-953-0237.*

**PLEASE REPLY TO:**

SCDHEC OFFICE OF OCEAN AND COASTAL RESOURCE MANAGEMENT  
1362 McMillan Avenue, Suite 400  
Charleston, South Carolina 29405

**Please refer to P/N# OCRM-08-229-E**

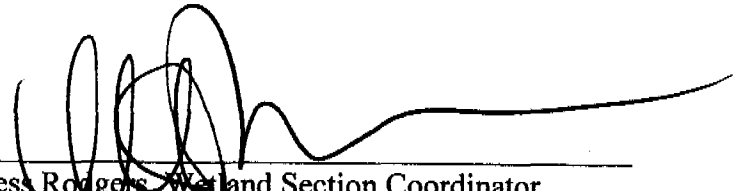
  
\_\_\_\_\_  
Tess Rodgers, Wetland Section Coordinator

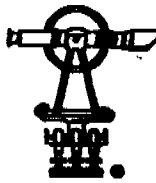

**GEORGE A.Z. JOHNSON, JR., INC.**  
**LAND SURVEYORS**

6171 Savannah Highway  
 Ravenel, South Carolina 29470  
 (843) 698-1498 Charleston No. 722-3882 Edisto No. 698-1498

OCRM Critical Line Certified by  
 Bill Elser May 13, 2008 and  
 shown on plat by GAZJ, Inc.  
 Dated 4/22/2008.

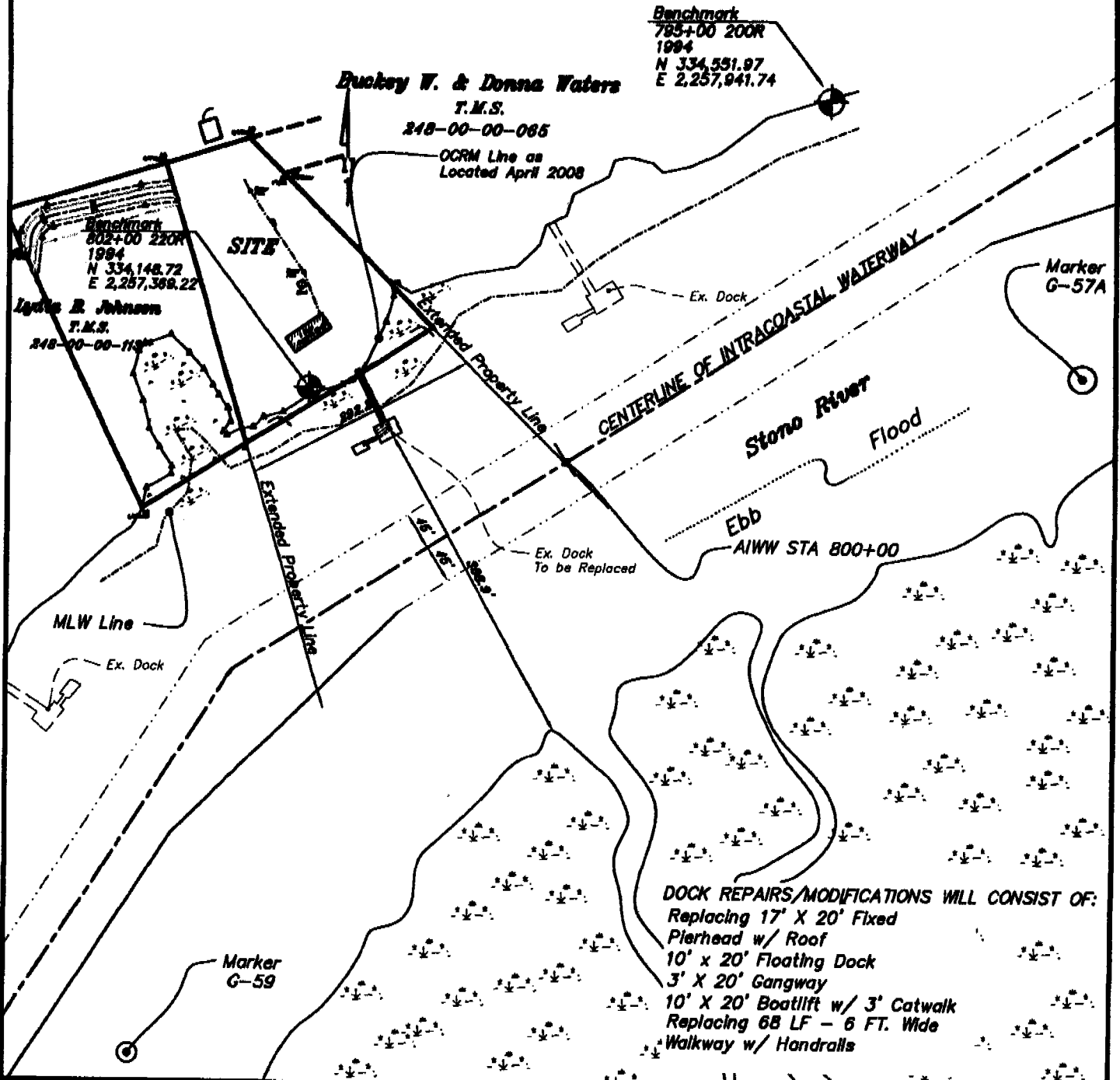

**DOCK REPAIRS/MODIFICATIONS WILL CONSIST OF:**  
 Replacing 17' X 20' Fixed  
 Pierhead w/ Roof  
 10' x 20' Floating Dock  
 3' X 20' Gangway  
 10' X 20' Boatlift w/ 3' Catwalk  
 Replacing 68 LF - 6 FT. Wide  
 Walkway w/ Handrails

Applicant: Robert T. Chipley  
 5031 Trexler Avenue  
 Hollywood, SC 29449  
 Charleston County  
 TMS No. 248-00-00-011  
 Stono River  
 GAZJ JOB # 22564  
  
 P/N# OCRM-08-229-E

**OVERALL PLAN  
 MODIFICATIONS TO  
 PRIVATE  
 RECREATIONAL DOCK  
 FOR TMS 248-00-00-011  
 DATE: March 30, 2009  
 SCALE "NTS"**  
  
 Sheet 2 of 4

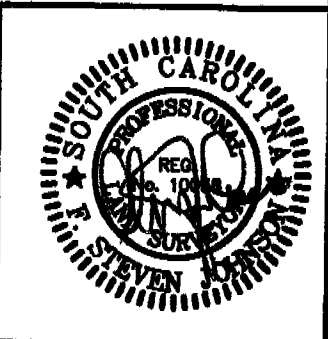

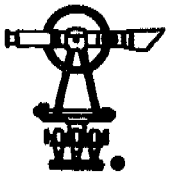

**GEORGE A.Z. JOHNSON, JR., INC.**  
**ENGINEERS · PLANNERS · LAND SURVEYORS**

6171 Savannah Highway  
 Ravenel, South Carolina 29476  
 (843) 688-1482 Charleston No. 722-3888 Edisto No. 688-1488

OCRM Critical Line Certified by  
 B&H Elser May 13, 2008 and  
 shown on plat by GAZJ, Inc.  
 Dated 4/22/2008.

**DOCK REPAIRS/MODIFICATIONS WILL CONSIST OF:**

- Replacing 17' X 20' Fixed Pierhead w/ Roof
- 10' x 20' Floating Dock
- 3' X 20' Gangway
- 10' X 20' Boatlift w/ 3' Catwalk
- Replacing 68 LF - 6 FT. Wide Walkway w/ Handrails

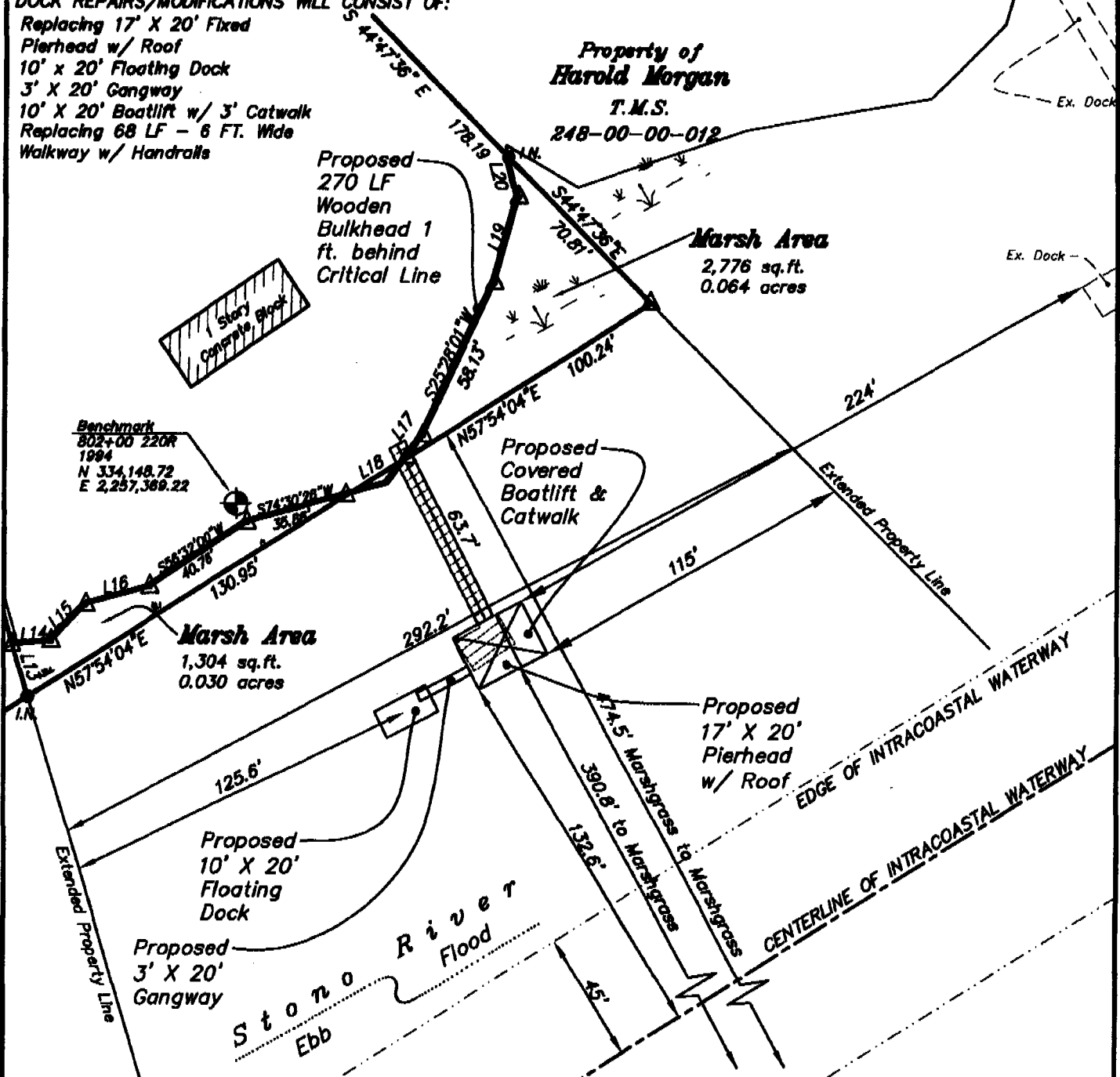

Applicant: Robert T. Chipley  
 5031 Trexler Avenue  
 Hollywood, SC 29449  
 Charleston County  
 TMS No. 248-00-00-011  
 Stono River  
 GAZJ JOB # 22564

DETAIL PLAN  
 MODIFICATIONS TO  
 PRIVATE  
 RECREATIONAL DOCK  
 FOR TMS 248-00-00-011  
 DATE: March 30, 2009  
 SCALE 1" = 50'



P/N# OCRM-08-229-E

OCRM Critical Line Certified by  
 Bill Eiser May 13, 2008 and  
 shown on plat by GAZI, Inc.  
 Dated 4/22/2008.

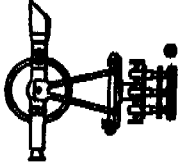

**GEORGE A.Z. JOHNSON, JR., INC.**  
**LAND SURVEYORS**

6171 Savannah Highway  
 Ravenel, South Carolina 29470  
 (843) 880-1482 Charleston No. 722-2002 Atlanta No. 888-1486

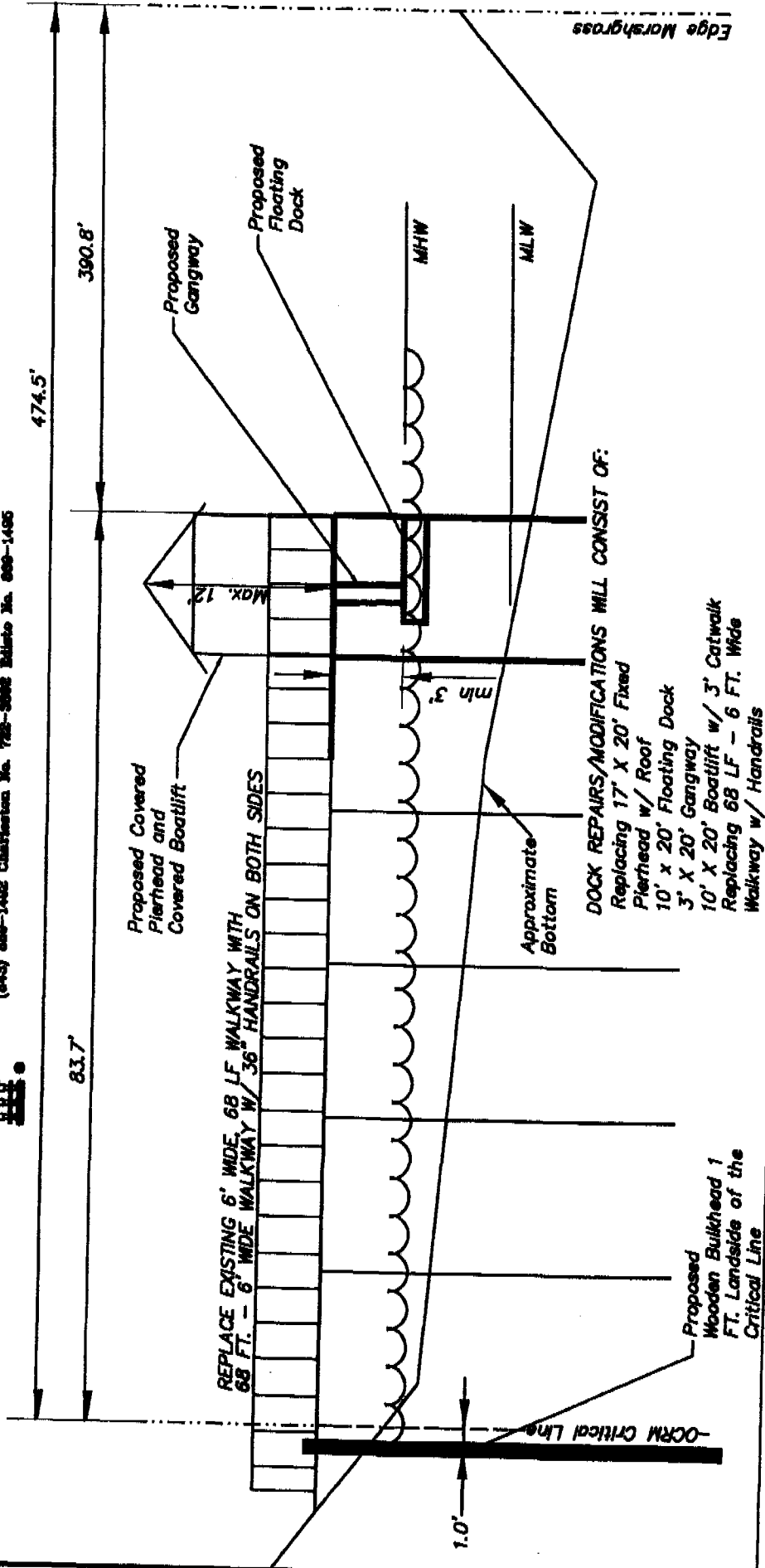

**DOCK REPAIRS/MODIFICATIONS WILL CONSIST OF:**  
 Replacing 17' X 20' Fixed Pierhead w/ Roof  
 10' X 20' Floating Dock  
 3' X 20' Gangway  
 10' X 20' Boatlift w/ 3' Catwalk  
 Replacing 68 LF - 6 FT. Wide Walkway w/ Handrails

**SIDE VIEW TO MODIFICATIONS TO PRIVATE RECREATIONAL DOCK**  
 FOR TMS 248-00-00-011  
 DATE: March 30, 2009  
 SCALE "NTS"

Sheet 4 of 4



P/N# OCRM-08-229-E

Property of  
The Limited Partnership  
T.M.S.  
248-00-00-010

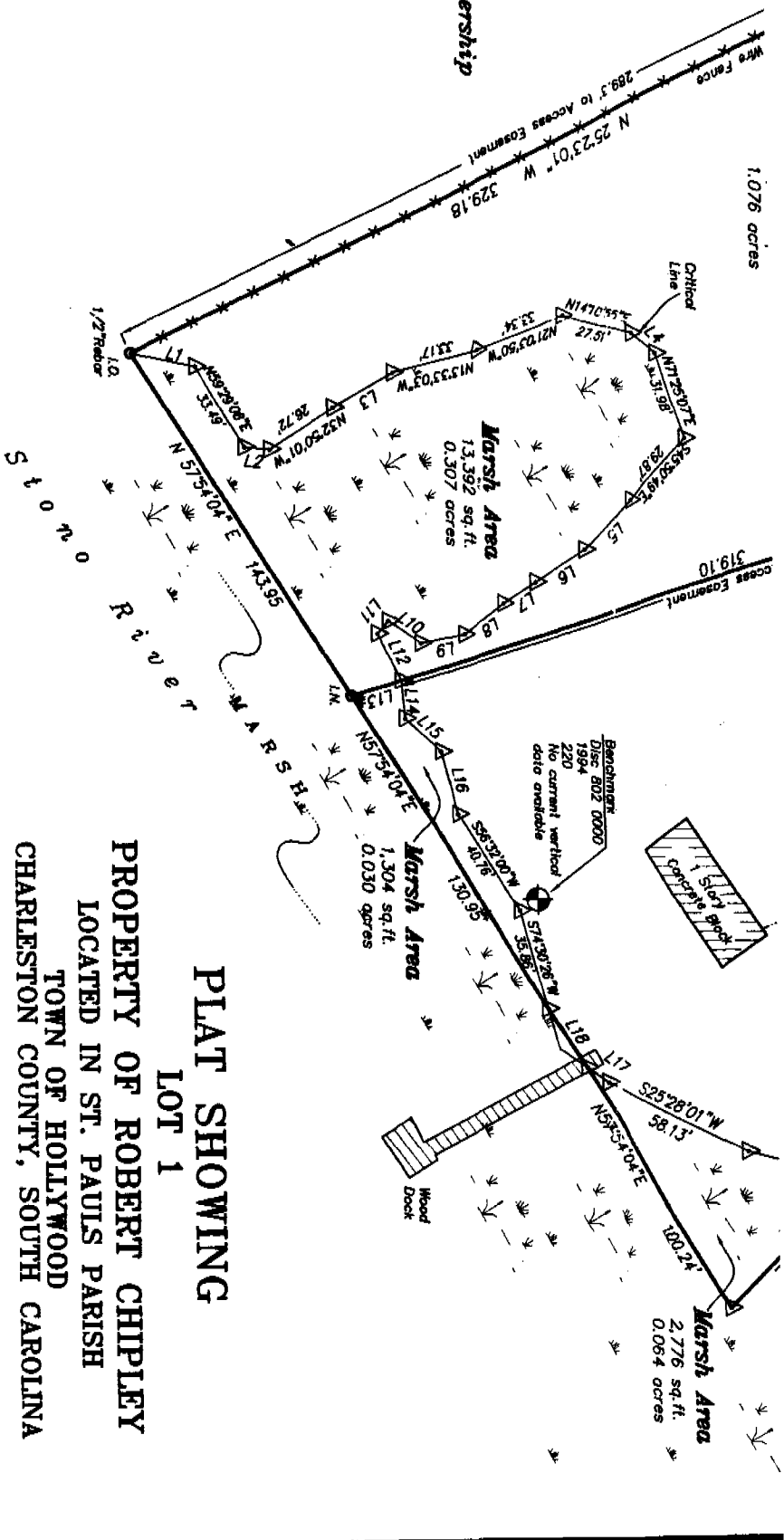

THE AREA SHOWN ON THIS PLAT IS A GENERAL REPRESENTATION OF OCRM PERMIT AUTHORITY ON THE SUBJECT PROPERTY. OF CRITICAL AREAS, BY THEIR NATURE, ARE DYNAMIC AND SUBJECT TO CHANGE OVER TIME BY GENERALLY DELINEATING THE PERMIT AUTHORITY OF THE OCRM, THE OCRM IN NO WAY WAIVES THE RIGHT TO ASSERT PERMIT JURISDICTION AT ANY TIME IN ANY CRITICAL AREA ON THE SUBJECT PROPERTY, WHETHER SHOWN HEREIN OR NOT.

Signature: W. Allen C. Egan DATE: 5/13/08

The critical line shown on this plat is valid for five years from the date of this signature, subject to the cautionary language above.

PLAT SHOWING  
LOT 1  
PROPERTY OF ROBERT CHIPLEY  
LOCATED IN ST. PAUL'S PARISH  
TOWN OF HOLLYWOOD  
CHARLESTON COUNTY, SOUTH CAROLINA

DATE: APRIL 22, 2008 SCALE: 1" = 40'

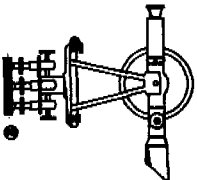

GEORGE A.Z. JOHNSON, JR., INC.  
LAND SURVEYORS  
6171 SAVANNAH HWY  
RAVENEL, S.C. 29470  
(843) 898-1492

Reduced, NTS  
12/9/08

OCRM-08-229-E

**GEORGE A.Z. JOHNSON, JR., INC.**  
**LAND SURVEYORS**

6171 Savannah Highway  
 Beaufort, South Carolina 295170  
 (843) 888-1482 Charleston No. 782-3888 Salto No. 888-1488

OCRM Critical Line Certified by  
 Bill Elser May 13, 2008 and  
 shown on plat by GAZJ, Inc.  
 Dated 4/22/2008.

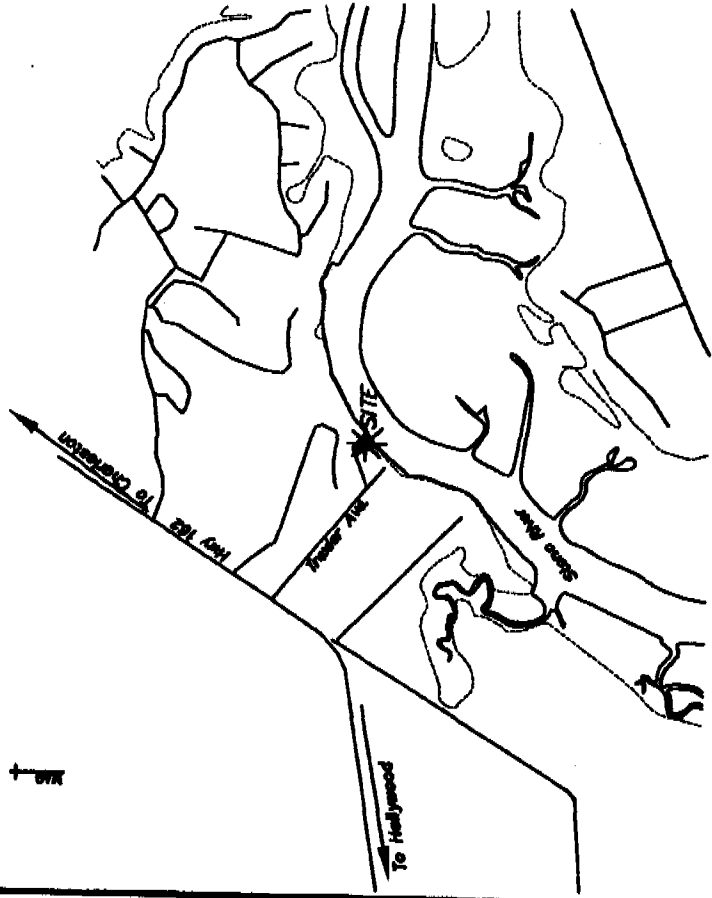

- 1: Start out going WEST on McMILLAN AVE/W 3RD ST toward AVENUE E S. 0.1 mi
- 2: Turn LEFT onto AVENUE E S. 0.1 mi
- 3: Turn RIGHT onto COSSGROVE AVE EXT. 0.2 mi
- 4: COSSGROVE AVE EXT becomes COSSGROVE AVE. 1.1 mi
- 5: COSSGROVE AVE becomes SC-7 S. 5.1 mi
- 6: Turn RIGHT onto SAVANNAH HWY/US-17 S/US-17 S. 7.3 mi
- 7: Turn SLIGHT LEFT onto SC-162 W. 2.5 m
- 8: Turn LEFT onto TREXLER AVE (Portions unpaved). 0.3 mi
- 9: End at 5031 Trexler Ave Hollyhock, SC 29449-5810

**DOCK REPAIRS/MODIFICATIONS WILL CONSIST OF:**  
 Replacing 17' X 20' Fixed  
 Pierhead w/ Roof  
 10' x 20' Floating Dock  
 3' X 20' Gangway  
 10' X 20' Boatlift w/ 3' Catwalk  
 Replacing 68 LF - 6 FT. Wide  
 Walkway w/ Handrails

*Location Map "NTS"*

Applicant: Robert T. Chipley  
 5031 Trexler Avenue  
 Hollyhock, SC 29449  
 Charleston County  
 TMS No. 248-00-00-011  
 Stono River  
 GAZJ JOB # 22564

P/N# OCRM-08-229-E

LOCATION MAP  
 MODIFICATIONS TO  
 PRIVATE  
 RECREATIONAL DOCK  
 FOR TMS 248-00-00-011  
 DATE: March 30, 2009  
 SCALE "NTS"

