

**SCDHEC OFFICE OF OCEAN AND COASTAL RESOURCE MANAGEMENT
PERMIT APPLICATION PUBLIC NOTICE**

April 24, 2009

Permit Number: OCRM-09-844-L
Permit ID: 66708

The SCDHEC Office of Ocean and Coastal Resource Management has received an application for a permit for the alteration of a critical area. This application was submitted pursuant to the Coastal Zone Management Act (Act 123) of the 1977 South Carolina General Assembly. The application, in brief, is described as follows:

APPLICANT: James A and Lake Daly
1132 Wilmington Island Road
Savannah GA 31410

LOCATION: On and adjacent to New River at 7296 Bellinger Hill Road, Hardeeville, Jasper County, South Carolina.
TMS#: 071-00-00-56.

WORK: The work as proposed and shown on the attached plans consists of constructing a private dock and a timber bulkhead. Specifically, the dock will have a 4'x6' walkway with handrails leading to a 20'x20' fixed pierhead with water and electricity. To the flood side of the pierhead will be a 4'x30' ramp leading to a 10'x20' floating dock. The purpose of the dock is for the applicant's private recreational use. Also proposed is an approximately 9' high by 320' long timber bulkhead. The purpose of the bulkhead is for erosion control.

This public notice is being distributed to all known interested persons and agencies to assist in developing facts on which a decision by OCRM can be based. Comments concerning the proposed work should be submitted in writing, setting forth sufficient detail to furnish a clear understanding of the reasons for support or opposition.

The decision to issue or deny a permit will be based on the individual merits of the application, the policies specified in the South Carolina Coastal Zone Management Act, and the considerations outlined in the State of South Carolina Coastal Zone Management Program. Interested parties who wish to be notified of final permit action must notify OCRM in writing of this request.

To assure review by OCRM, comments regarding this application must be received by OCRM on or before May 9, 2009. For further information please contact the project manager for this activity, Kathleen Lamaker at 843-846-9400.

PLEASE REPLY TO:
SCDHEC OFFICE OF OCEAN AND COASTAL RESOURCE MANAGEMENT
104 Parker Drive
Beaufort, South Carolina 29906

Please refer to P/N# OCRM-09-844-L

K Lamaker

Kathleen Lamaker, Wetland Section Project Manager

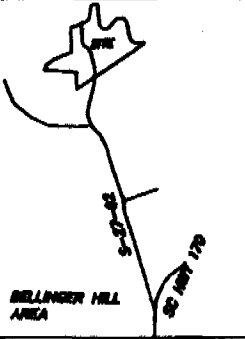

VICINITY MAP NOT TO SCALE

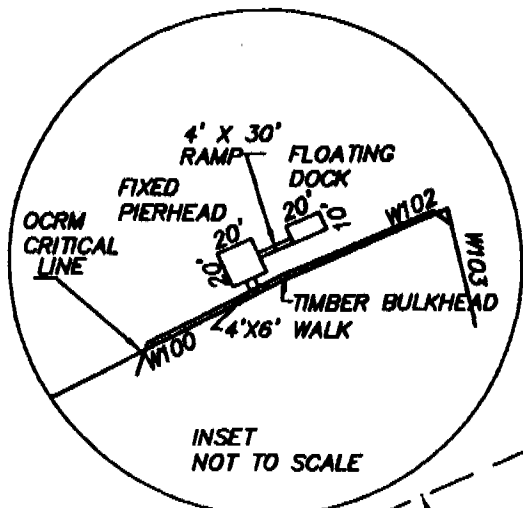

PLAT REFERENCE:

1. COMPILATION PLAT BY TGS LAND SURVEYING



NEW RIVER

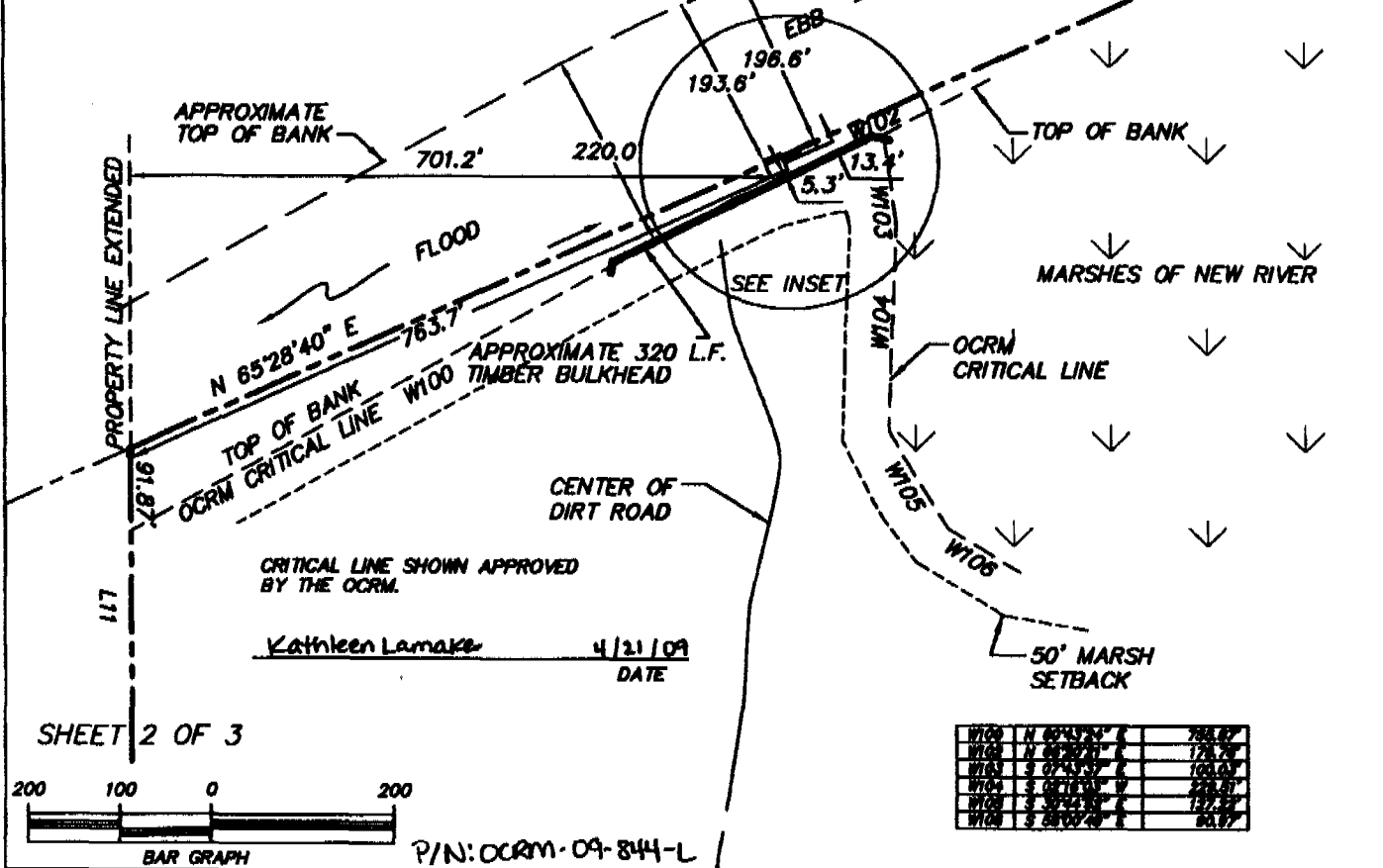

SHEET 2 OF 3

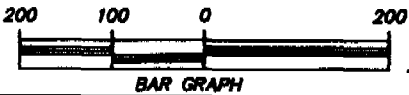

P/N: OCRM-09-844-L

W100	N 65°28'40" E	763.7'
W101	S 88°20'21" W	178.24'
W102	S 87°43'37" W	168.60'
W103	S 87°18'00" W	238.20'
W104	S 30°43'28" E	137.37'
W105	S 88°00'40" E	60.17'



Matthew D. Clark

4/2/09

MATTHEW D. CLARK, SC RLS NO. 20187



A & C PROFESSIONAL SURVEYING, INC.

P.O. BOX 531 HARDEEVILLE, SC 29927

OFFICE (843) 784-3100

FAX (843) 784-2858

www.ocsurvey.com

SUBDIVISION: -

LOT No. -

BLOCK -

PLAT BOOK:

SCALE: 1" = 200'

DATE: FEBRUARY 19, 2009

JOB No. 08144

DRAWN BY: MDC

PLAN VIEW OF PROPOSED PIER HEAD AND FLOATING DOCK

GOOD HOPE PLANTATION DOCK PERMIT/SITE JASPER COUNTY, S.C.

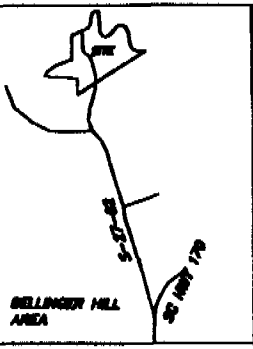

VICINITY MAP NOT TO SCALE

NOTES:

- 1) AREA WAS DETERMINED BY THE COORDINATE METHOD.
- 2) ANYTHING SHOWN OUTSIDE THE DEFINED BOUNDARY IS FOR DESCRIPTIVE PURPOSE ONLY.
- 3) THE PUBLIC RECORDS REFERENCED ON THIS PLAT ARE ONLY USED AND/OR NECESSARY TO THE ESTABLISHMENT OF THE BOUNDARY OF THIS PROPERTY. THEY ARE NOT AND DO NOT CONSTITUTE A TITLE SEARCH.
- 4) DISTANCE SHOWN HEREON ARE HORIZONTAL GROUND DISTANCES.
- 5) NO SUBSURFACE OR ENVIRONMENTAL INVESTIGATION OR SURVEYS WERE PERFORMED FOR THIS PLAT. THEREFORE THIS PLAT DOES NOT REFLECT THE EXISTENCE OR NONEXISTENCE OF WETLANDS, CONTAMINATION, OR OTHER CONDITIONS WHICH MAY AFFECT THIS PROPERTY.

PLAT REFERENCE:

1. COMPILATION PLAT BY TGS LAND SURVEYING.

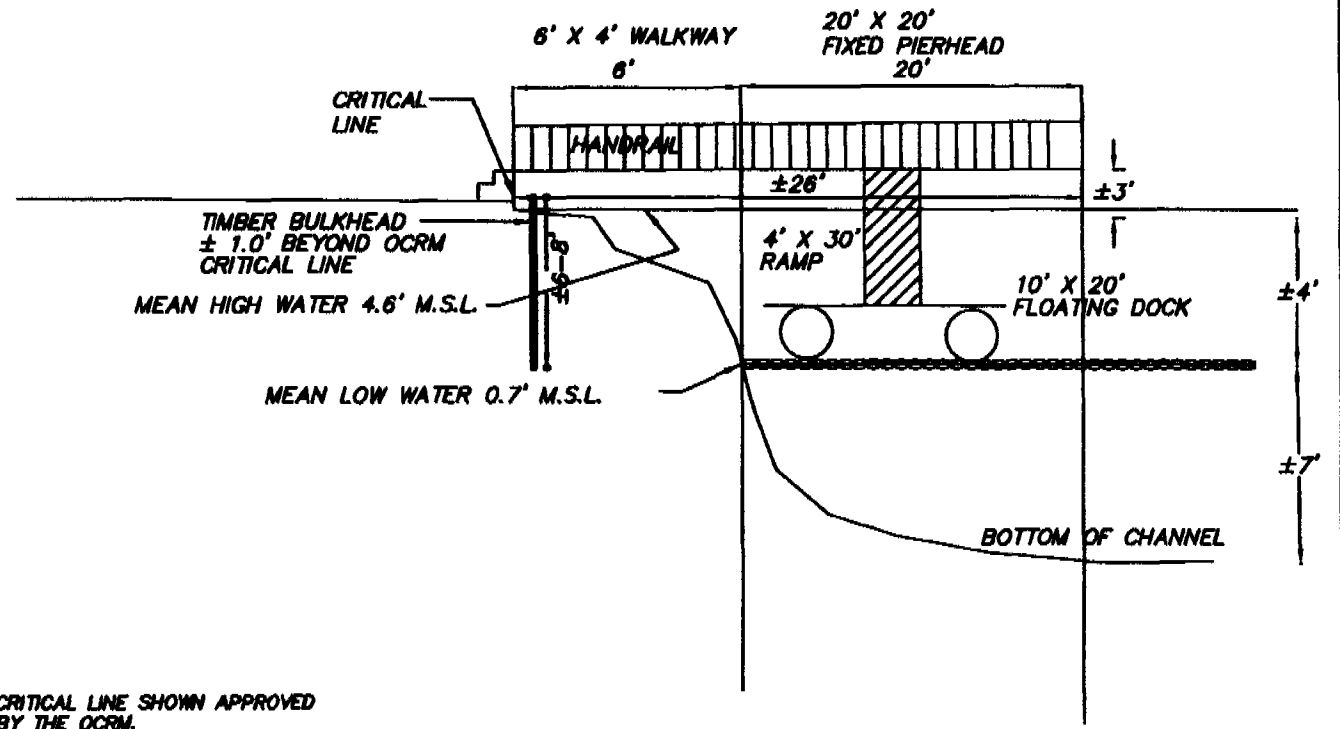

CRITICAL LINE SHOWN APPROVED BY THE OCRM.

Kathleen Lamaker 4/21/09
DATE

SHEET 3 OF 3 P/N: OCRM-09-844-L

NOT TO SCALE

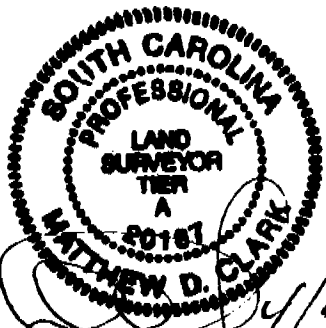

Matthew D. Clark
4/21/09
MATTHEW D. CLARK, SC RLS NO. 20187



A & C
PROFESSIONAL
SURVEYING, INC.
P.O. BOX 531
HARDEEVILLE, SC 29927
OFFICE (843) 784-3100
FAX (843) 784-2858
www.acsurvey.com

SUBDIVISION: -
LOT No. -
BLOCK -
PLAT BOOK:
SCALE: 1" = 200'
DATE: FEBRUARY 19, 2009
JOB No. 08144
DRAWN BY: MDC

PREPARED FOR: JAMES DALY

**PROFILE OF
PROPOSED PIER HEAD AND
FLOATING DOCK**

GOOD HOPE PLANTATION DOCK PERMIT/PROFILE JASPER COUNTY, S.C.

MAPQUEST

Sorry! When printing directly from the browser your directions or maps may not print correctly. For best results, try clicking the Printer-Friendly button.

Beaufort, SC



5759 Bellinger Hill Rd
Hardeeville, SC 29927-9447

Total Estimated Time: 58 minutes
Total Estimated Distance: 36.45 miles
Total Estimated Fuel Cost:

▼ Directions from A to B:

- 1: Start out going WEST on CARTERET ST/US-21 BR toward PORT REPUBLIC ST. Continue to follow US-21 BR. 1.5 mi
- 2: US-21 BR becomes BOUNDARY ST/US-21. 1.1 mi
- 3: Turn SLIGHT LEFT onto ROBERT SMALLS PKWY/SC-170. Continue to follow SC-170 S. 25.8 mi
- 4: Stay STRAIGHT to go onto SC-170 ALTHWY 170A. 3.8 mi
- 5: Turn SLIGHT LEFT onto SC-S-27-92. 1.6 mi
- 6: Turn LEFT onto WILDCAT RD. 2.0 mi
- 7: Turn LEFT onto SC-S-27-92. 0.1 mi
- 8: SC-S-27-92 becomes BELLINGER HILL RD. 0.0 mi
- 9: End at 7296 Bellinger Hill Rd Hardeeville, SC 29927-9447

Estimated Time: 58 minutes Estimated Distance: 36.45 miles

Total Estimated Time: 58 minutes

Total Estimated Distance: 36.45 miles

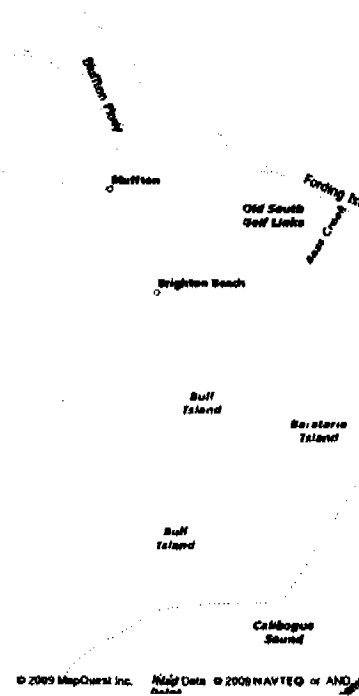
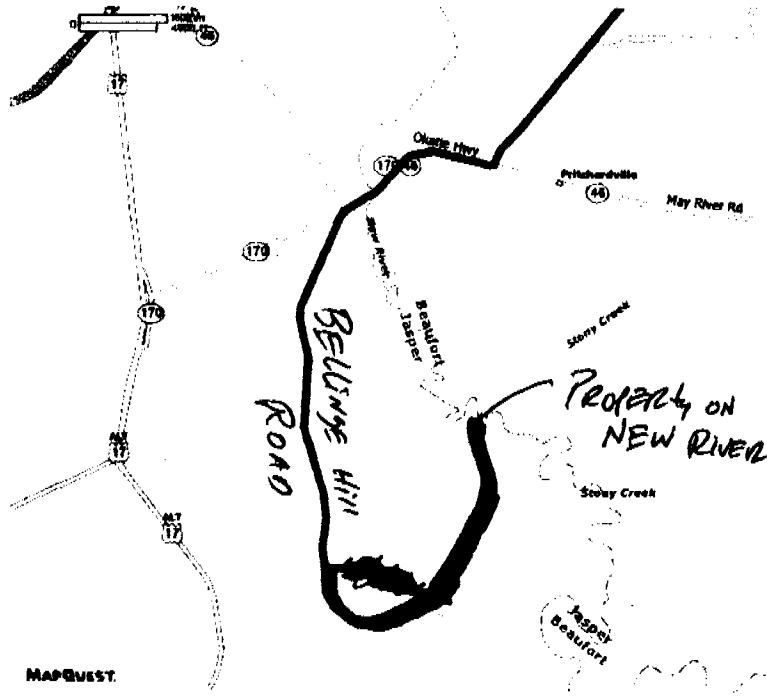

MAPQUEST

All rights reserved. Use subject to License/Copyright Map Legend
Directions and maps are informational only. We make no warranties on the accuracy of their content, road conditions or route usability or speed/accuracy. You assume all risk of use. MapQuest and its suppliers shall not be liable to you for any loss or delay resulting from your use of MapQuest. Your use of MapQuest means you agree to our Terms of Use

JAMES A. and LAKE DALY
7296 BELLINGER HILL ROAD
HARDEEVILLE SC 29927

JASPER COUNTY
PIN: OCRM-09-844-L