

**SCDHEC OFFICE OF OCEAN AND COASTAL RESOURCE MANAGEMENT
PERMIT APPLICATION PUBLIC NOTICE**

April 24, 2009 (revised)

Permit Number: OCRM-09-016-T
Permit ID: 64617

The SCDHEC Office of Ocean and Coastal Resource Management has received an application for a permit for the alteration of a critical area. This application was submitted pursuant to the Coastal Zone Management Act (Act 123) of the 1977 South Carolina General Assembly. The application, in brief, is described as follows:

APPLICANT: Fred Sullivan
C/O Malcolm Baldwin
PO Box 625
McClellanville, SC 29458

LOCATION: On and adjacent to a tidal ditch off Jeremy Creek at Society Rd, McClellanville, Charleston County, South Carolina. TMS#: 764-00-00-166

WORK: The work as proposed and shown on the attached drawings consists of constructing two bulkheads and replacing two old reinforced concrete pipes with two new 48' long by 48" wide reinforced concrete pipes for a road crossings. Specifically, the applicant seeks to construct two bulkheads to prevent further erosion to an existing road crossing. The replacement of the existing RCP will be to allow a larger flow of water which will in turn help prevent further erosion of the road crossing and ditch edges. The work as described is to provide erosion control at an existing crossing. **Please note:** This project was previously placed on public notice on March 6, 2009 and this notice is to provide the public the chance to comment on these revisions.

This public notice is being distributed to all known interested persons and agencies to assist in developing facts on which a decision by OCRM can be based. Comments concerning the proposed work should be submitted in writing, setting forth sufficient detail to furnish a clear understanding of the reasons for support or opposition.

The decision to issue or deny a permit will be based on the individual merits of the application, the policies specified in the South Carolina Coastal Zone Management Act, and the considerations outlined in the State of South Carolina Coastal Zone Management Program. Interested parties who wish to be notified of final permit action must notify OCRM in writing of this request.

To assure review by OCRM, comments regarding this application must be received by OCRM on or before May 24, 2009. For further information please contact the project manager for this activity, James Trumbull at 843-953-0218.

PLEASE REPLY TO:

SCDHEC OFFICE OF OCEAN AND COASTAL RESOURCE MANAGEMENT
1362 McMillan Avenue, Suite 400
Charleston, South Carolina 29405

Please refer to P/N# OCRM-09-016-T

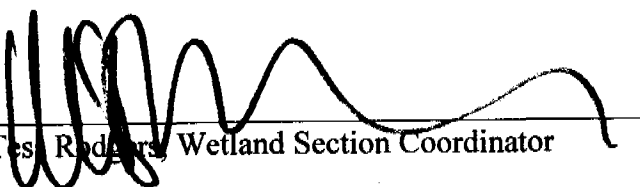

Tes Rodgers, Wetland Section Coordinator

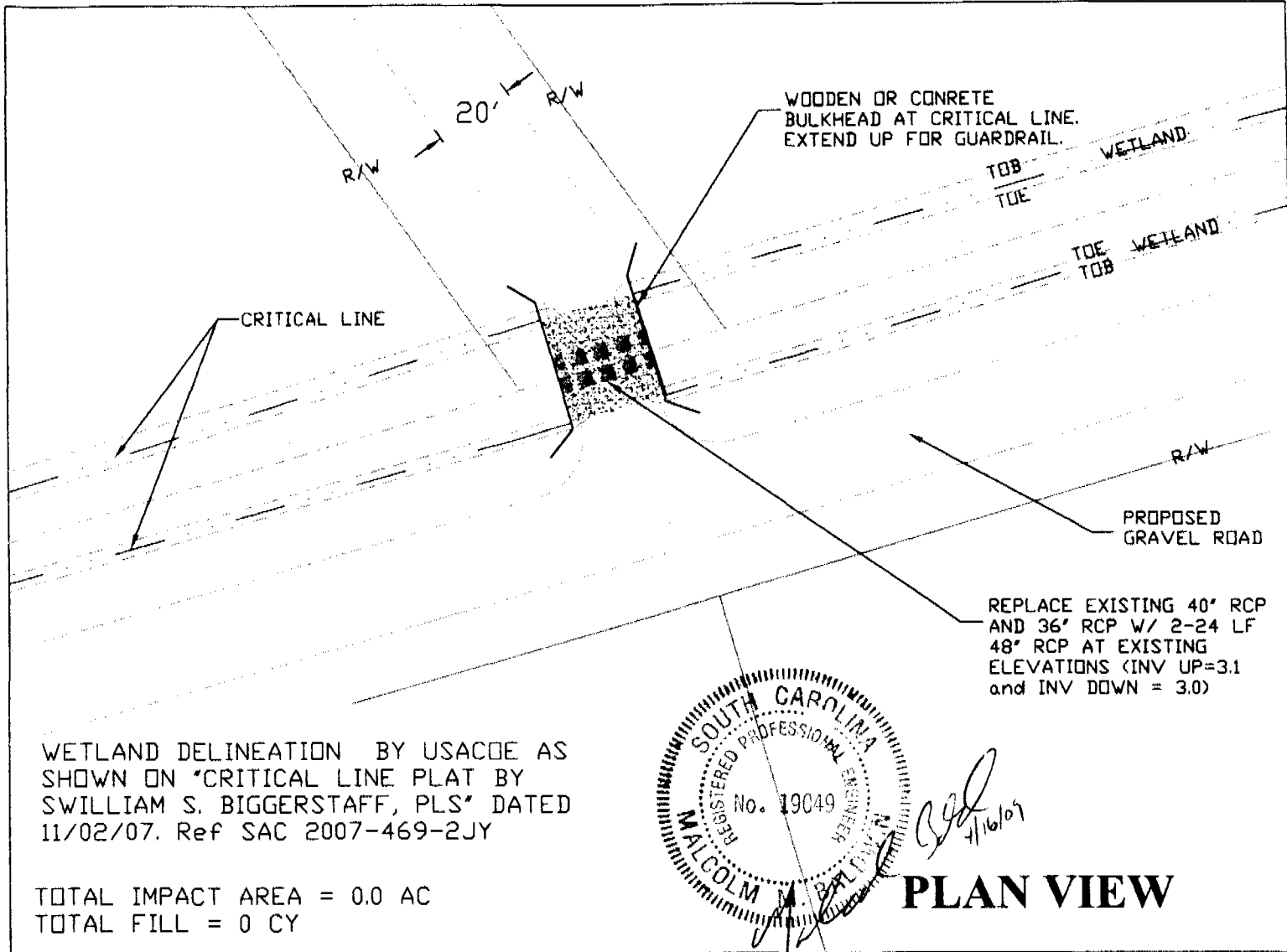

PLAN VIEW

WETLAND DELINEATION BY USACOE AS SHOWN ON "CRITICAL LINE PLAT BY SWILLIAM S. BIGGERSTAFF, PLS" DATED 11/02/07. Ref SAC 2007-469-2JY

TOTAL IMPACT AREA = 0.0 AC
 TOTAL FILL = 0 CY

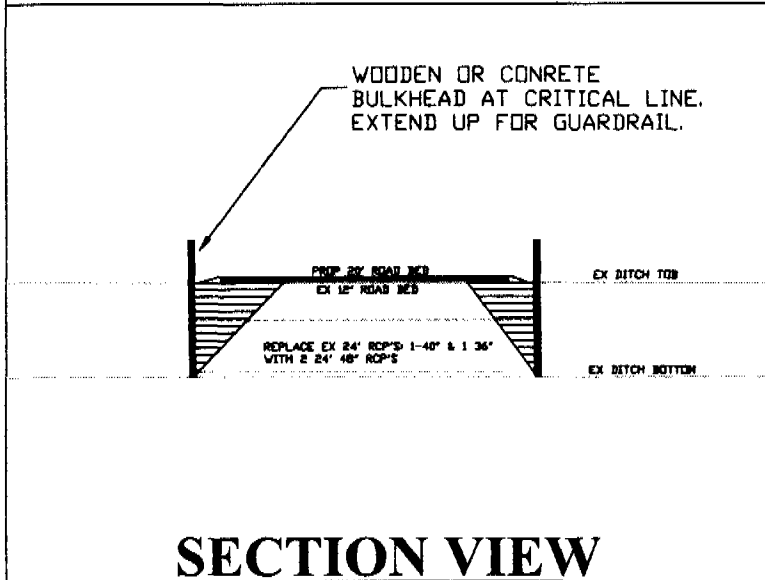

SECTION VIEW

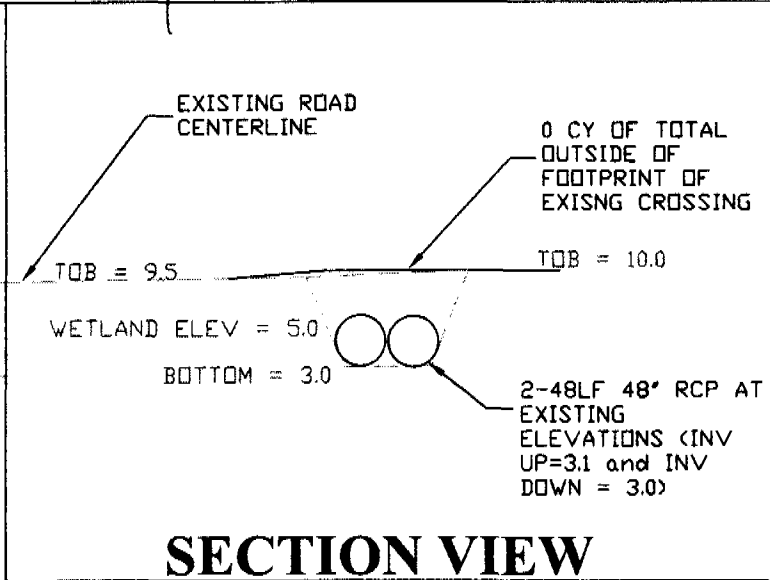

SECTION VIEW



PREPARED BY:
MALCOLM BALDWIN, PE, LLC
 829 PINCKNEY ST, SUITE C; PO BOX 625
 McCLELLANVILLE, SC
 (843) 697-4340 FAX (843) 887-3701
 malcolm@fivefathom.com

EXHIBIT "A"

FAIR OAKS SUBDIVISION
McClellanville, SC

REV DATE: 04/15/09
 SCALE: 1"=40'

JCR 11-09-016-T

- GENERAL NOTES:**
- 1 THIS 744-00-00-106
 - 2 BOUNDARY FROM COMPILED PLATS. THIS OFFICE HAS PERFORMED NO SURVEY.
 - 3 SEE SHEET 3 FOR DETAILS.
 - 4 SOILS ON-SITE: PACTOLUS (Cm), FOXWORTH(LuB), WINTERBUSH(SM), AND RUTLEDGE (RQ).

- LEGEND**
- EX ROAD
 - RIGHT-OF-WAY
 - EX TOPD LINE
 - PROP TOPD LINE
 - EX DRAINAGE
 - SILT FENCE

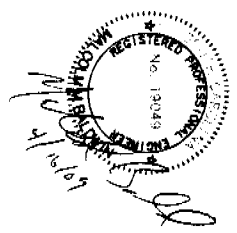
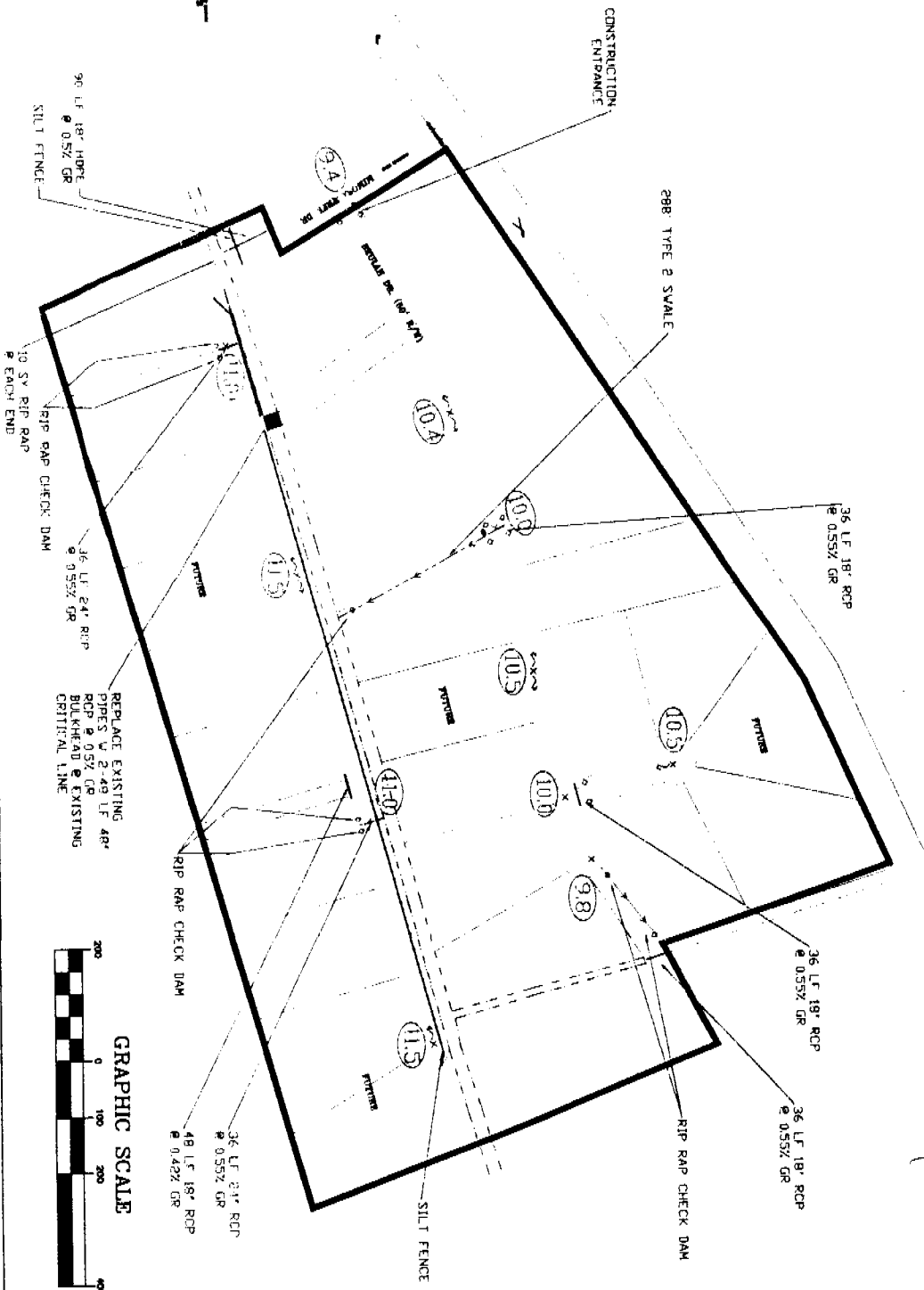

<p>PREPARED BY: MALCOLM BALDWIN, PE, LLC. DEVELOPMENT CONSULTING 829 PINCKNEY ST, SUITE C, PO BOX 625 McCLELLANVILLE, SC 29458 (843) 697-4340 FAX: (843) 887-3701</p>	<p>REVISIONS</p> <p>REV PER OCRM 04/14/09</p>	<p>FAIR OAKS SUBDIVISION McCLELLANVILLE, SC</p>	<p>DRAINAGE PLAN</p>
			<p>DATE: 01/11/08</p> <p>SCALE: 1" = 200'</p> <p>SHEET 1 OF 3</p>

OCRM-09-016-7

Send To Printer Back To TerraServer Change to 11x17 Print Size Remove Grid Lines Change to Landscape

USGS 1 km SE of McClellanville, South Carolina, United States 01 Jul 1983

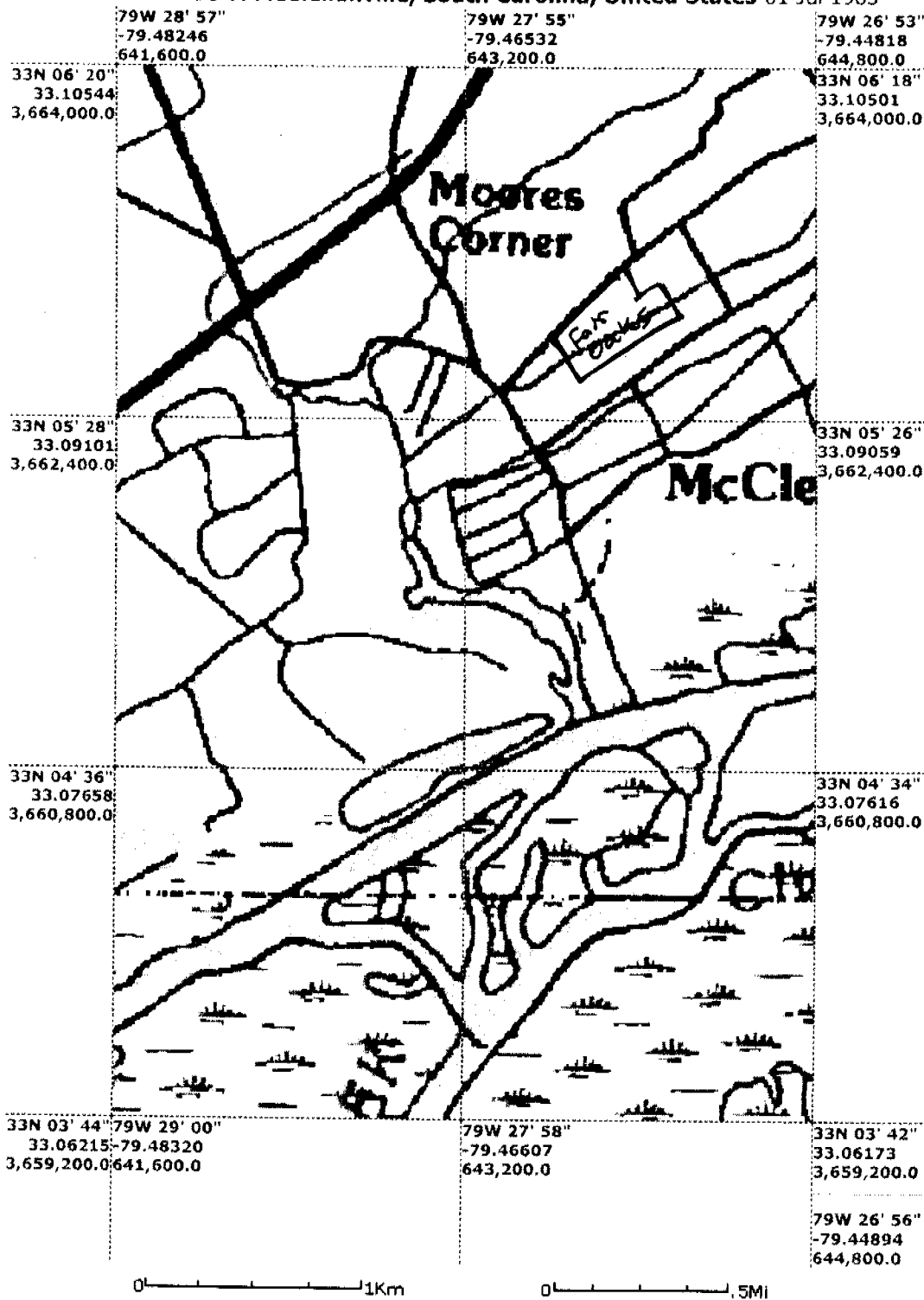

Image courtesy of the U.S. Geological Survey
© 2004 Microsoft Corporation. **Terms of Use** **Privacy Statement**

JCR M-09-016-T

*Location Map for
Fair Oaks Subdivision
McClellanville, SC*