

**SCDHEC OFFICE OF OCEAN AND COASTAL RESOURCE MANAGEMENT
PERMIT APPLICATION PUBLIC NOTICE**

May 8, 2009

Permit Number: OCRM-09-047-B
Permit ID: 66799

The SCDHEC Office of Ocean and Coastal Resource Management has received an application for a permit for the alteration of a critical area. This application was submitted pursuant to the Coastal Zone Management Act (Act 123) of the 1977 South Carolina General Assembly. The application, in brief, is described as follows:

APPLICANT: Mary Dawson
C/O Wade Surveying
P.O. Box 686
Isle of Palms, South Carolina 29451

LOCATION: On and adjacent to Atlantic Intracoastal Waterway at 18 Intracoastal Court, Isle of Palms, Charleston County, South Carolina. TMS#'s 571-07-00-132.

WORK: The work as proposed and shown on the attached drawings consists of making additions to an existing dock. Specifically, the applicant proposes to construct a roof over the existing 20' x 20' pierhead, install new benches on the pierhead. Ebbside of the floating dock, the applicant proposes to add a new 12' x 12', four-pile boatlift. The work as described is for the applicant's private, recreational use.

This public notice is being distributed to all known interested persons and agencies to assist in developing facts on which a decision by OCRM can be based. Comments concerning the proposed work should be submitted in writing, setting forth sufficient detail to furnish a clear understanding of the reasons for support or opposition.

The decision to issue or deny a permit will be based on the individual merits of the application, the policies specified in the South Carolina Coastal Zone Management Act, and the considerations outlined in the State of South Carolina Coastal Zone Management Program. Interested parties who wish to be notified of final permit action must notify OCRM in writing of this request.

To assure review by OCRM, comments regarding this application must be received by OCRM on or before May 23, 2009. For further information please contact the project manager for this activity, Steven Brooks at (843) 953-0235.

PLEASE REPLY TO:

SCDHEC OFFICE OF OCEAN AND COASTAL RESOURCE MANAGEMENT
1362 McMillan Avenue, Suite 400
Charleston, South Carolina 29405

Please refer to P/N# OCRM-09-047-B

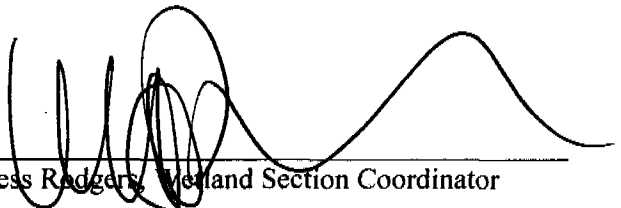
Tess Rodgers, Wetland Section Coordinator

CRITICAL LINE AS SHOWN
 IS DUPLICATE TO LINE
 AS SHOWN ON SURVEY
 BY JOHN E WADE JR.
 DATED JULY 11, 2008
 SIGNED BY OCRM
 STEVE BROOKS 12-29-08

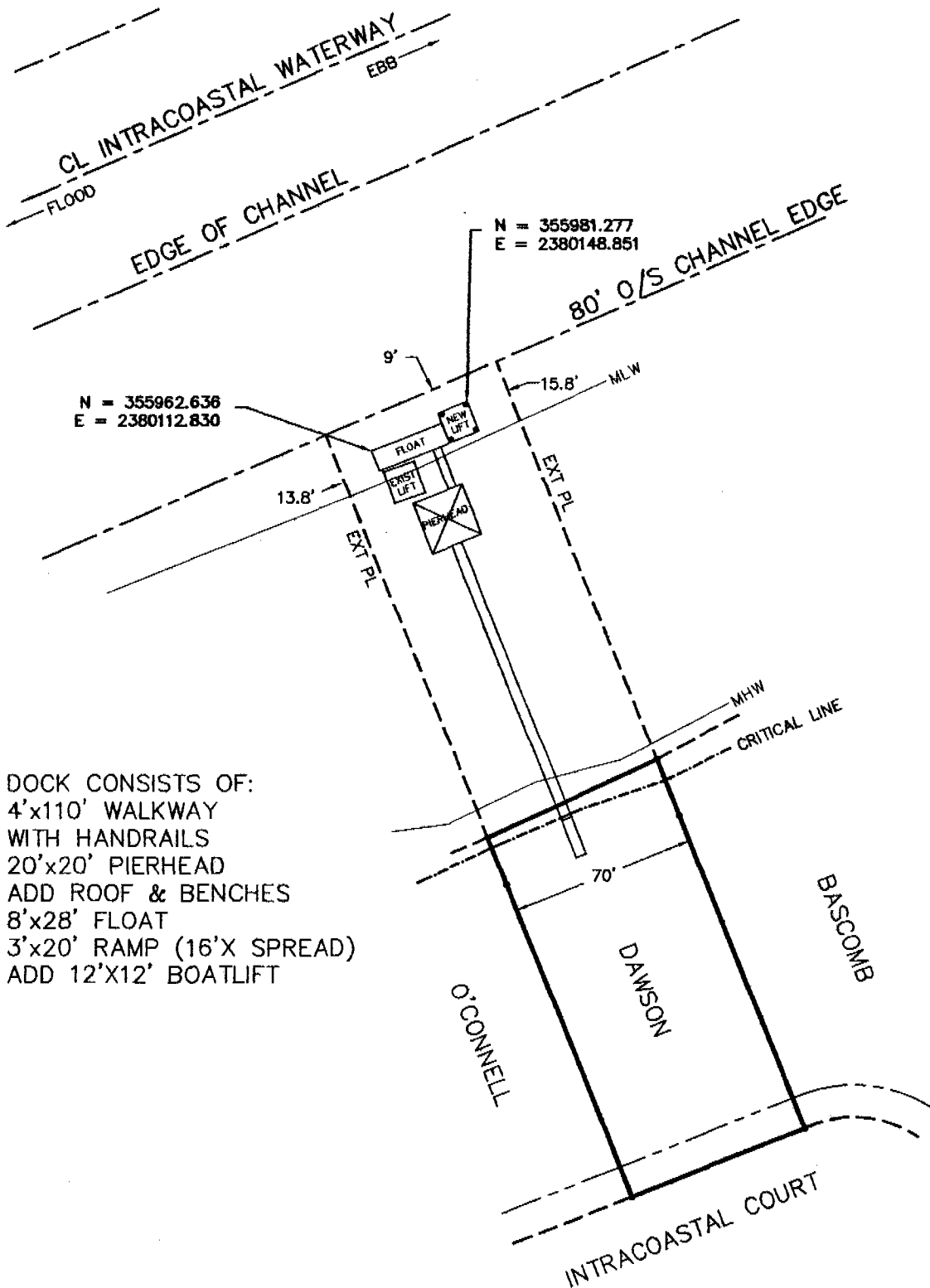

DOCK CONSISTS OF:
 4'x110' WALKWAY
 WITH HANDRAILS
 20'x20' PIERHEAD
 ADD ROOF & BENCHES
 8'x28' FLOAT
 3'x20' RAMP (16'X SPREAD)
 ADD 12'X12' BOATLIFT

OCRM-09-047-8

APPLICANT: MARY DAWSON
 #18 INTRACOASTAL COURT
 CITY OF ISLE OF PALMS
 CHARLESTON COUNTY
 TMS# 571-07-00-132
 INTRACOASTAL WATERWAY

MODIFY EXISTING
 PRIVATE RECREATIONAL
 DOCK

DATE: APRIL 3, 2009
 SCALE: 1" = 60'



FILE #093-08D

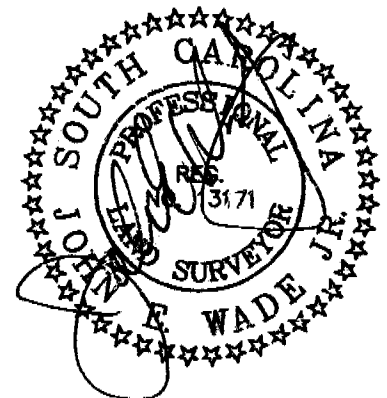

80' OS CHANNEL EDGE

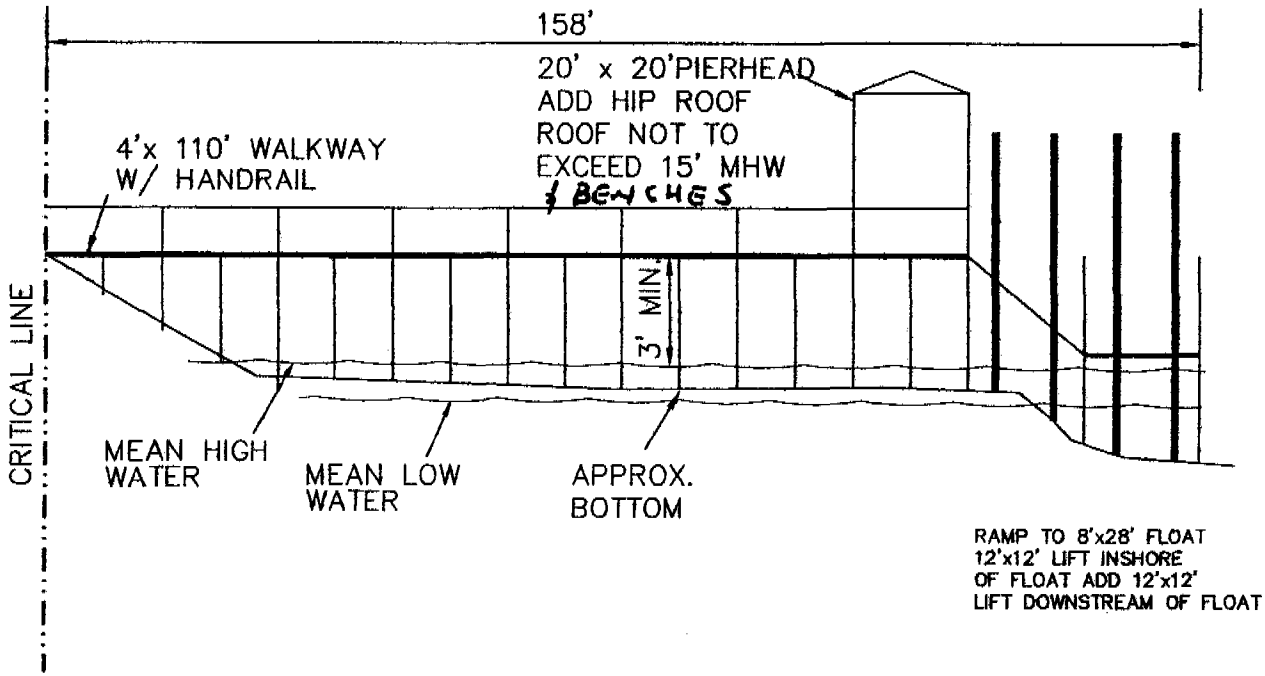
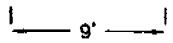

OCR-09-047-B

APPLICANT: MARY DAWSON
 #18 INTRACOASTAL COURT
 CITY OF ISLE OF PALMS
 CHARLESTON COUNTY
 TMS# 571-07-00-132
 INTRACOASTAL WATERWAY

MODIFY EXISTING
 PRIVATE RECREATIONAL
 DOCK
 DATE: APRIL 3, 2009
 NO SCALE

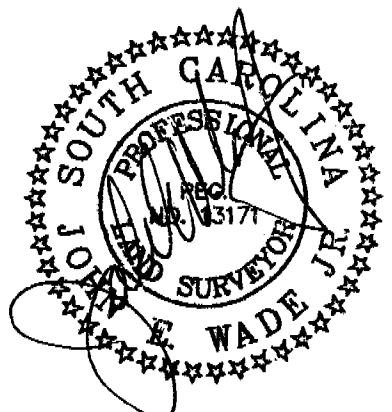

FILE #093-08D



Charleston County

Copyright 2004
Charleston County GIS
4045 Bridge View Drive
North Charleston, SC 29405-7464

Legend

Selected Features

Streets/Roads

Parcels

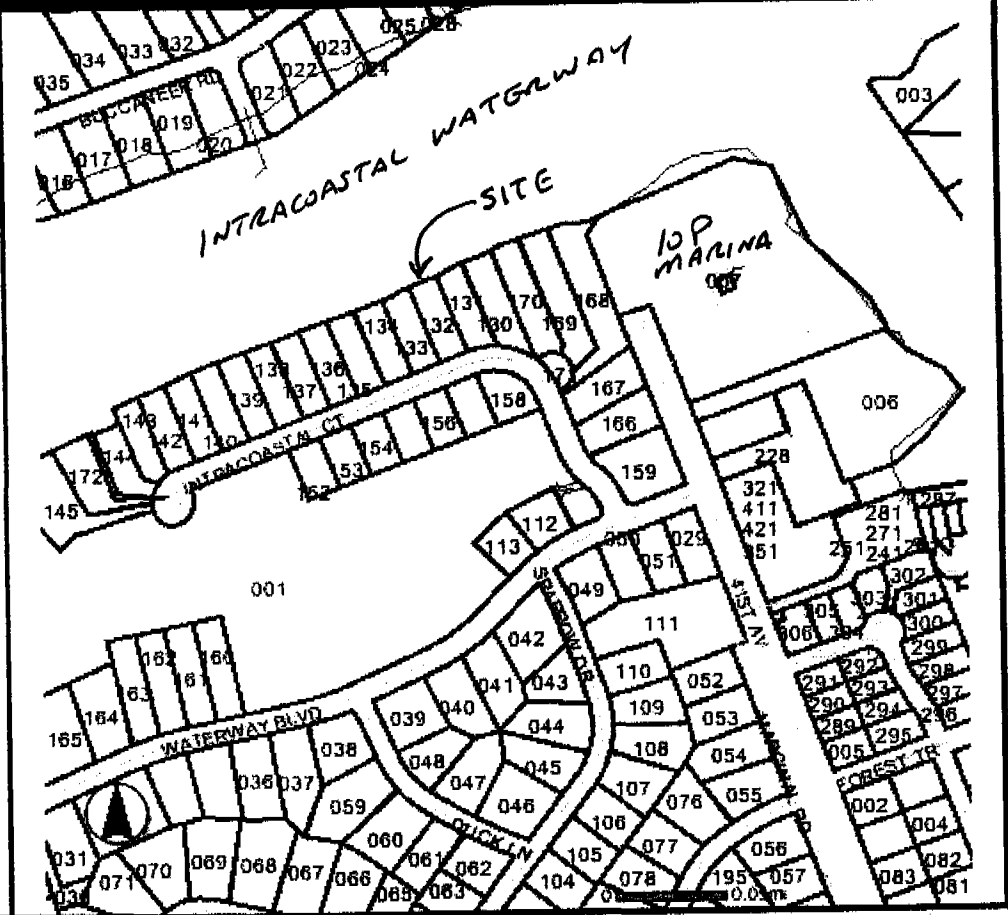

MARY DAWSON
 #18 INTRACOASTAL COURT
 ISLE OF PALMS
 TMS # 571-07-00-132
 INTRACOASTAL WATERWAY
 OCRM-09-047-B