

**SCDHEC OFFICE OF OCEAN AND COASTAL RESOURCE MANAGEMENT
PERMIT APPLICATION PUBLIC NOTICE**

June 12, 2009

Permit Number: OCRM-09-061-M
Permit ID: 67074

The SCDHEC Office of Ocean and Coastal Resource Management has received an application for a permit for the alteration of a critical area. This application was submitted pursuant to the Coastal Zone Management Act (Act 123) of the 1977 South Carolina General Assembly. The application, in brief, is described as follows:

APPLICANT: R. Stanley Jones
C/O Robert Frank Land Surveying
1923 Maybank Hwy
Charleston, SC 29455

LOCATION: On and adjacent to the Yacht Basin at 308 Jungle Shores Road, Edisto Beach, Colleton County, South Carolina. TMS#: 356-15-00-031.

WORK: The work as proposed and shown on the attached plans consists of making additions to an existing dock. Specifically, the applicant proposes to install two boatlifts adjacent to that structure. The first boatlift will be a 12' by 12', four-pile structure installed on the floodside of the existing 15' by 20' fixed pierhead. The second proposed boatlift is a 6' by 8' single-pile structure, installed landward of the existing 10' by 25' floating dock. The work as described is for the applicant's private, recreational use.

This public notice is being distributed to all known interested persons and agencies to assist in developing facts on which a decision by OCRM can be based. Comments concerning the proposed work should be submitted in writing, setting forth sufficient detail to furnish a clear understanding of the reasons for support or opposition.

The decision to issue or deny a permit will be based on the individual merits of the application, the policies specified in the South Carolina Coastal Zone Management Act, and the considerations outlined in the State of South Carolina Coastal Zone Management Program. Interested parties who wish to be notified of final permit action must notify OCRM in writing of this request.

To assure review by OCRM, comments regarding this application must be received by OCRM on or before June 27, 2009. For further information please contact the project manager for this activity, Fred Mallett, at 843-953-0236.

PLEASE REPLY TO:

SCDHEC OFFICE OF OCEAN AND COASTAL RESOURCE MANAGEMENT
1362 McMillan Avenue, Suite 400
Charleston, South Carolina 29405

Please refer to P/N# OCRM-09-061-M



Tess Rodgers, Wetland Section Coordinator

DIMENSIONS FOR EXISTING DOCK:
 4' X 115' WALKWAY W/HANDRAILS,
 15' X 20' FIXED PIERHEAD W/ROOF,
 3' X 16' RAMP, 10' X 25' FLOAT

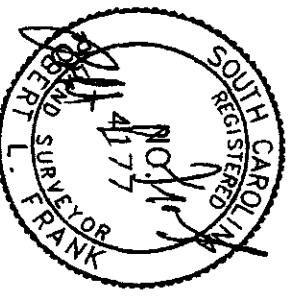

APPLICATION BY:
 R. STANLEY JONES
 ADDRESS: 308 JUNGLE SHORES RD.
 DATE: MAY 21, 2009
 REVISED:

- ADJOINING PROPERTY OWNERS:
 1. CHARLES AND BERNICE ROGERS (TO THE NORTHWEST)
 2. SERENA R. CLARK (TO THE SOUTHEAST)

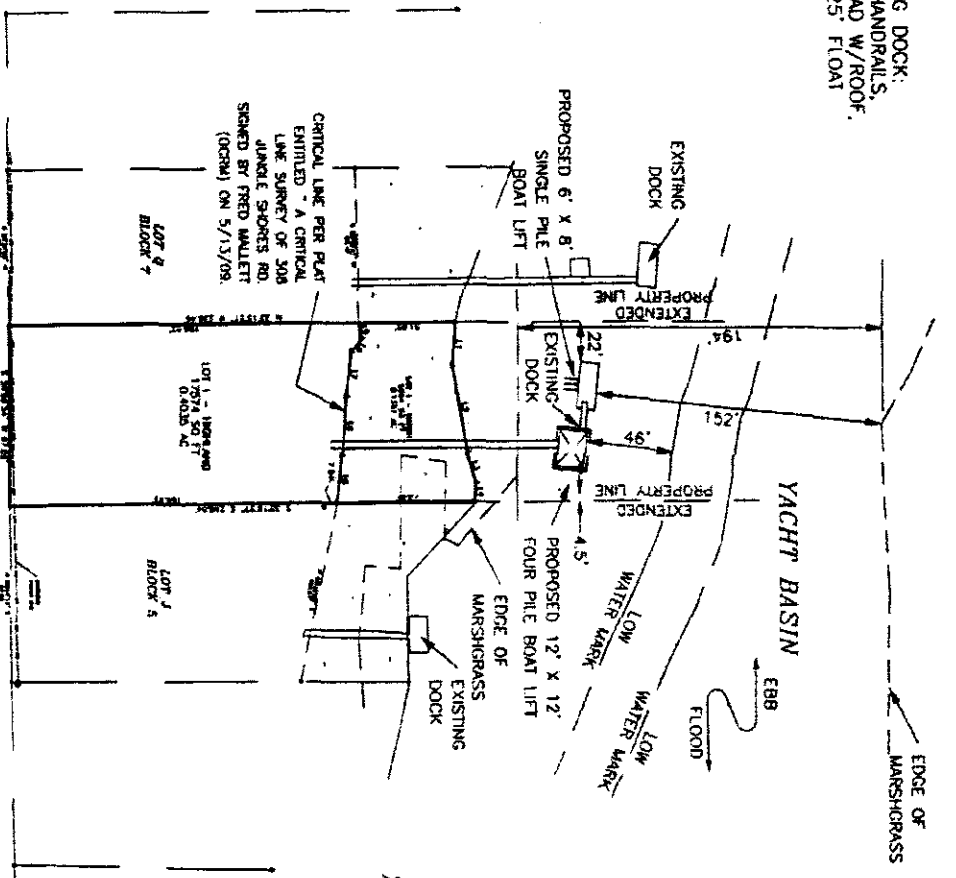

NUMBER	DIRECTION	DISTANCE
L1	N 62°05'33" E	23.66'
L2	N 47°10'23" E	46.87'
L3	N 41°15'03" E	17.65'
L4	N 59°54'56" E	10.31'
L5	S 62°50'24" W	26.16'
L6	S 60°28'35" W	31.40'
L7	S 63°57'39" W	24.32'
L8	N 86°07'52" W	9.08'
L9	S 47°06'47" W	8.50'

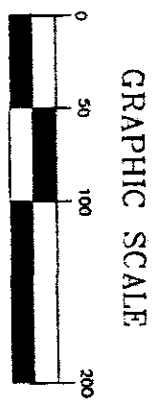

LOCATION
 PROPOSED BOAT LIFT
 ADDITIONS TO AN EXISTING
 RECREATIONAL DOCK AT
 308 JUNGLE SHORES RD.
 EDISTO BEACH
 COLLETON COUNTY, SC

SHT. NAME
 FULL PLAN
 VIEW
 OCRM-09-061-M

SHT. NO.
 4 OF 5

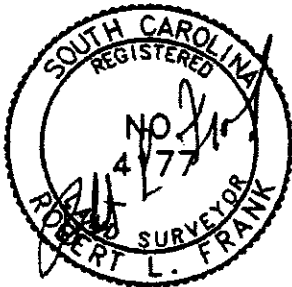
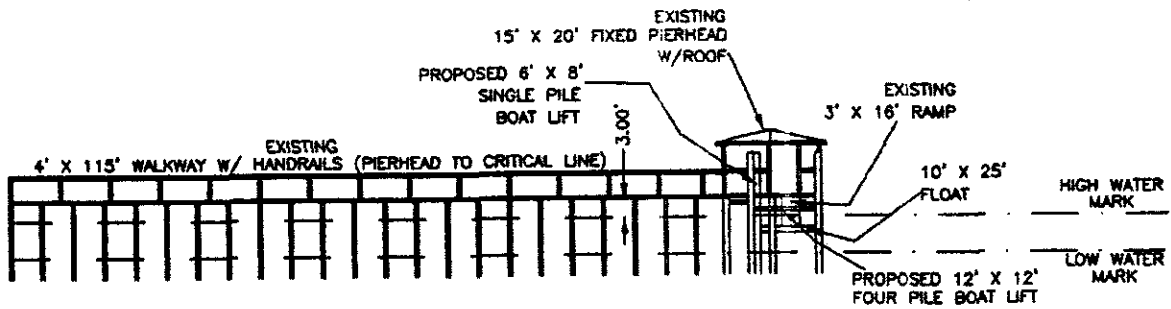
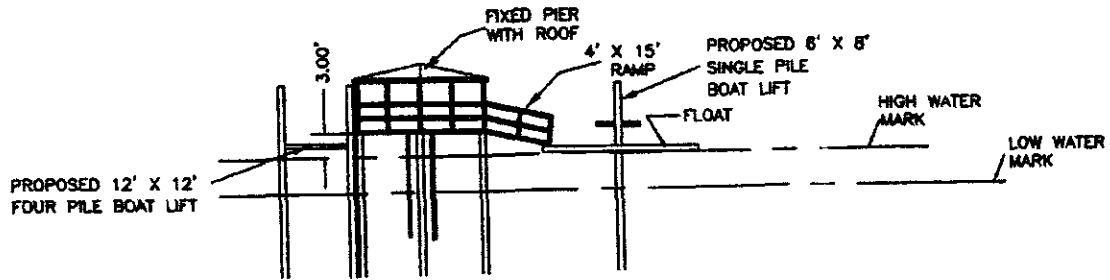

GRAPHIC SCALE



(IN FEET)

1 inch = 30 ft.

TMS #356-15-00-031

- ADJOINING PROPERTY OWNERS:
 1. CHARLES AND BERNICE ROGERS (TO THE NORTHWEST)
 2. SERENA R. CLARK (TO THE SOUTHEAST)

APPLICATION BY: R. STANLEY JONES ADDRESS: 308 JUNGLE SHORES RD. DATE: MAY 21, 2009 REVISED:	LOCATION PROPOSED BOAT LIFT ADDITIONS TO AN EXISTING RECREATIONAL DOCK AT 308 JUNGLE SHORES RD. EDISTO BEACH COLLETON COUNTY, SC	SHT. NAME PLAN AND PROFILE OCRM-09-061-M	SHT. NO. 5 OF 5
---	--	---	--------------------

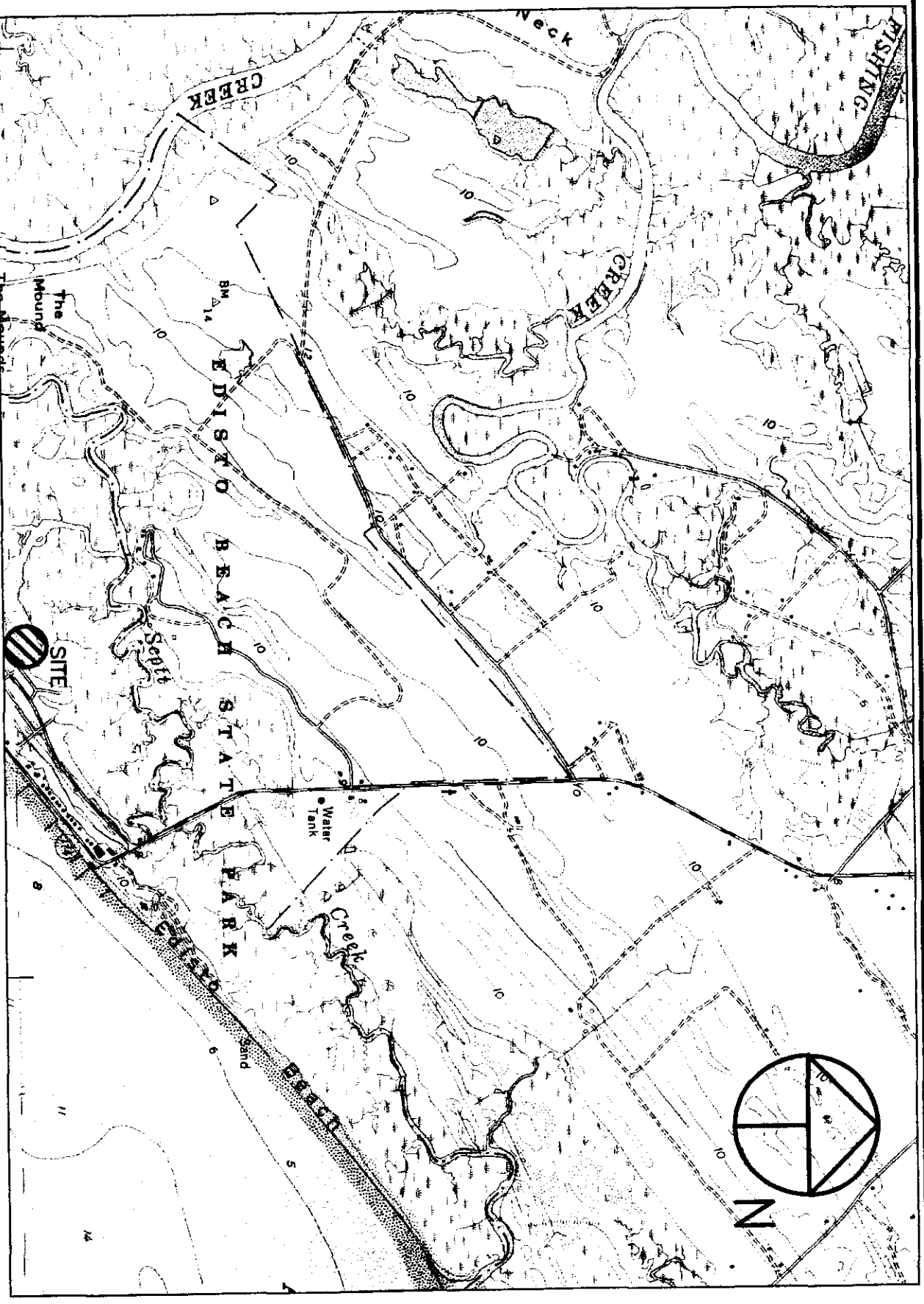

- ADJOINING PROPERTY OWNERS:
 1. CHARLES AND BERNICE ROGERS (TO THE NORTHWEST)
 2. SERENA R. CLARK (TO THE SOUTHEAST)

APPLICATION BY:
 R. STANLEY JONES
 ADDRESS: 308 JUNGLE SHORES RD.
 DATE: MAY 21, 2009
 REVISIONS:

LOCATION
 PROPOSED BOAT LIFT
 ADDITIONS TO AN EXISTING
 RECREATIONAL DOCK AT
 308 JUNGLE SHORES RD.
 EDISTO BEACH
 COLLETON COUNTY, SC

SHT. NAME
 OCRM-09-061-M
 EDISTO ISLAND
 QUADRANGLE MAP
 PROJECT LATITUDE/LONGITUDE:
 LATITUDE - 32°29'58"
 LONGITUDE - 80°18'28"

SHT. NO.
 3 OF 5

TWS #356-15-00-031