

**SCDHEC OFFICE OF OCEAN AND COASTAL RESOURCE MANAGEMENT
PERMIT APPLICATION PUBLIC NOTICE**

June 12, 2009

Permit Number: OCRM-09-522-A
Permit ID: 67051

The SCDHEC Office of Ocean and Coastal Resource Management has received an application for a permit for the alteration of a critical area. This application was submitted pursuant to the Coastal Zone Management Act (Act 123) of the 1977 South Carolina General Assembly. The application, in brief, is described as follows:

APPLICANT: Ocean Development Partners
c/o Robert L. Solomon
2990 Old Altman Rd
Conway SC 29526-7719

LOCATION: On and adjacent to Man-Made Canal at 300 53rd Ave N, North Myrtle Beach, Horry County, South Carolina.
TMS#: 145-03-22-020.

WORK: The work, as proposed and shown on the attached plans consists of constructing a replacement bulkhead. Specifically the applicant seeks to remove the existing wall and replace with an 80' long vinyl bulkhead. The existing dock and floating dock will be reattached upon bulkhead completion. The purpose of proposed activity is for erosion control.

This public notice is being distributed to all known interested persons and agencies to assist in developing facts on which a decision by OCRM can be based. Comments concerning the proposed work should be submitted in writing, setting forth sufficient detail to furnish a clear understanding of the reasons for support or opposition.

The decision to issue or deny a permit will be based on the individual merits of the application, the policies specified in the South Carolina Coastal Zone Management Act, and the considerations outlined in the State of South Carolina Coastal Zone Management Program. Interested parties who wish to be notified of final permit action must notify OCRM in writing of this request.

To assure review by OCRM, comments regarding this application must be received by OCRM on or before June 27, 2009. For further information please contact the project manager for this activity, Tanitra S. Marshall at 843-238-4528.

PLEASE REPLY TO:

SCDHEC OFFICE OF OCEAN AND COASTAL RESOURCE MANAGEMENT
927 Shine Avenue
Myrtle Beach, South Carolina 29577

Please refer to P/N# OCRM-09-522-A



Tanitra S. Marshall, Project Manager

STATE OF SOUTH CAROLINA
 DATE: MAY 18, 2009
 FILE NO. 2009-11

COUNTY OF HORRY
 SCALE: 1"=40'
 TAX MAP NO. 145-03-22-020

LINE	BEARING	DISTANCE
L1	S20°34'50"E	24.82'
L2	N69°05'10"E	25.00'
L3	S20°57'45"E	25.00'

The Critical Area line is the existing bulkhead.
 Verified by T. Marshall on June 9, 2009 per survey
 by James Godfrey dated May 18, 2009.

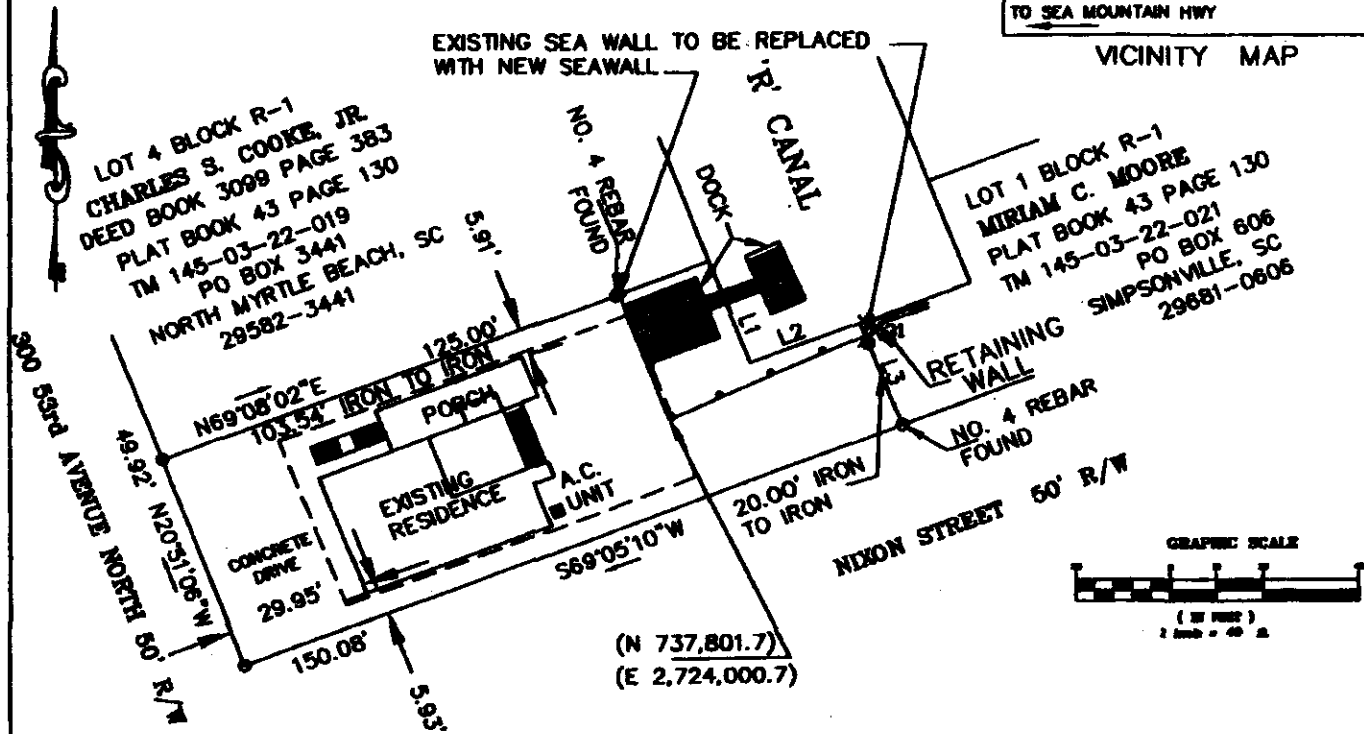
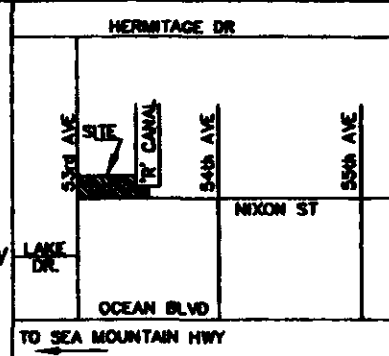

LOT 2 BLOCK R-1 AS SHOWN ON A COMPILED MAP OF PORTIONS OF SECTIONS 1 & 2
 CHERRY GROVE BEACH, SC BY S.D. COX RLS DATED AUGUST 20, 1951 AND REVISED
 MAY 15, 1953 AND RECORDED IN PLAT BOOK 43 PAGE 130 SAID LOT CONTAINS 0.15
 ACRES
 PRIVATE RECREATIONAL SEAWALL APPLICATION FOR

OCEAN DEVELOPMENT PARTNERS, LLC

James B. Godfrey III
 JAMES B. GODFREY III PLS



WILLIAM M. JONES JR. PLS
 OCEAN-09-522-A
 ASSOCIATES INC.
 FLORENCE, S.C. 29502

JONES/GODFREY AND
 P. O. BOX 6891 SHEET 1 OF 2

STATE OF SOUTH CAROLINA
DATE: MAY 18, 2009
FILE NO. 2009-11

COUNTY OF HORRY
SCALE: 1"=5'
TAX MAP NO. 145-03-22-020

(N737,801.7)
(E 2,724,000.7)

ELEVATIONS ARE BASED ON
NAVD 88 DATUM

LOT 4 BLOCK R-1
CHARLES S. COOKE, JR.
TM 145-03-22-019

LOT 1 BLOCK R-1
MIRIAM C. MOORE
TM 145-03-22-021

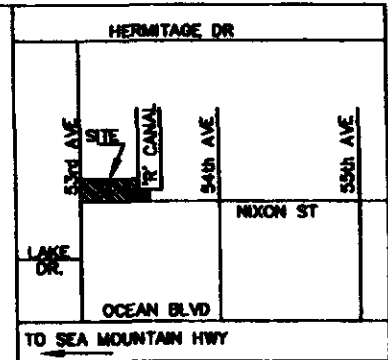

VICINITY MAP

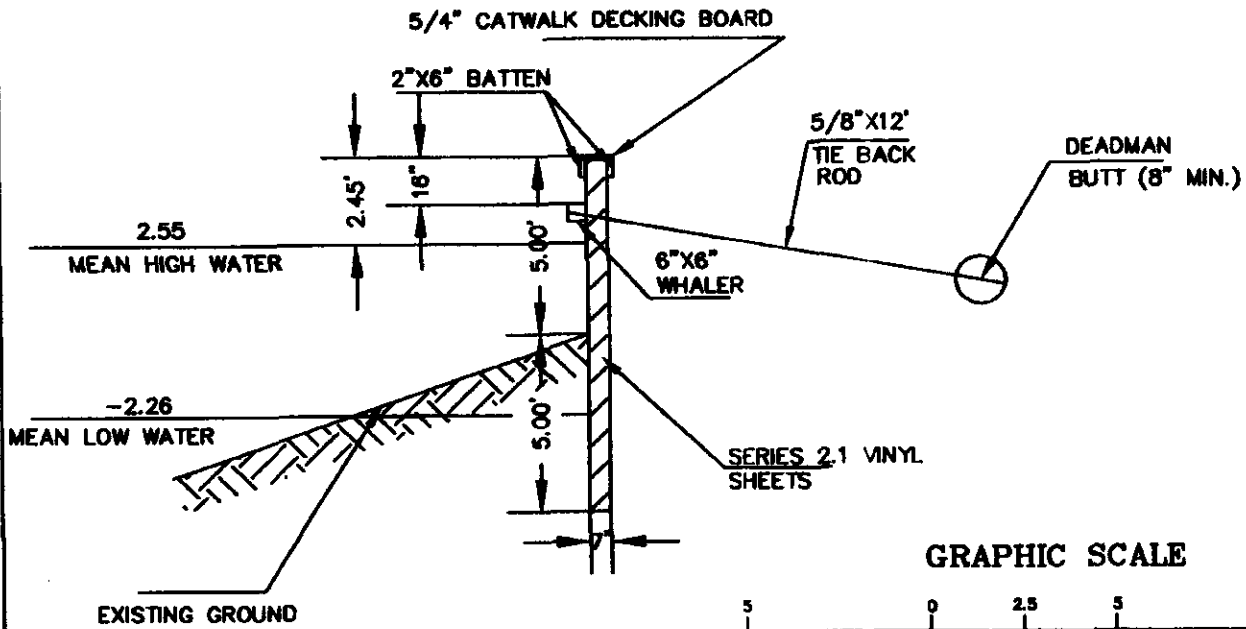

GRAPHIC SCALE

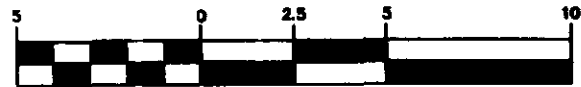

(IN FEET)

1 inch = 5 ft.

SEAWALL REPLACEMENT / CROSS SECTION

OCEAN DEVELOPMENT PARTNERS, LLC.

James B. Godfrey III
JAMES B. GODFREY III PLS



WILLIAM M. JONES JR. PLS

JONES/GODFREY AND
P. O. BOX 6891

SHEET 2 OF 2

OCEAN-09-522 A
ASSOCIATES INC.
FLORENCE, S.C. 29502