

**SCDHEC OFFICE OF OCEAN AND COASTAL RESOURCE MANAGEMENT
PERMIT APPLICATION PUBLIC NOTICE**

July 3, 2009

Permit Number: OCRM-09-878-L
Permit ID: 67282

The SCDHEC Office of Ocean and Coastal Resource Management has received an application for a permit for the alteration of a critical area. This application was submitted pursuant to the Coastal Zone Management Act (Act 123) of the 1977 South Carolina General Assembly. The application, in brief, is described as follows:

APPLICANT: Michael Hahn
C/o Atlantic Marine Construction Co Inc
372 County Shed Road
Beaufort SC 29906

LOCATION: On and adjacent to May River at 18 Myrtle Island Road, Bluffton, Beaufort County, South Carolina. TMS#: R600-039-00C-0494-0000.

WORK: The work as proposed and shown on the attached plans consists of constructing a private dock. Specifically, the structure will have a 4'x86' walkway with handrails leading to a 22'x25' covered fixed pierhead and boatlift combination structure. Channelward of the pierhead and boatlift structure will be a 4'x24' ramp leading to a 10'x30' floating dock. To the ebb side of the floating dock will be a 13'x15' four-pile boatlift. A 3'x18' catwalk will be channelward of the pierhead leading to the boatlift. The purpose of the activity is for the applicant's private recreational use.

This public notice is being distributed to all known interested persons and agencies to assist in developing facts on which a decision by OCRM can be based. Comments concerning the proposed work should be submitted in writing, setting forth sufficient detail to furnish a clear understanding of the reasons for support or opposition.

The decision to issue or deny a permit will be based on the individual merits of the application, the policies specified in the South Carolina Coastal Zone Management Act, and the considerations outlined in the State of South Carolina Coastal Zone Management Program. Interested parties who wish to be notified of final permit action must notify OCRM in writing of this request.

To assure review by OCRM, comments regarding this application must be received by OCRM on or before July 18, 2009. For further information please contact the project manager for this activity, Kathleen Lamaker at 843-846-9400.

PLEASE REPLY TO:
SCDHEC OFFICE OF OCEAN AND COASTAL RESOURCE MANAGEMENT
104 Parker Drive
Beaufort, South Carolina 29906

Please refer to P/N# OCRM-09-878-L



Kathleen Lamaker, Wetland Section Project Manager

67-1970

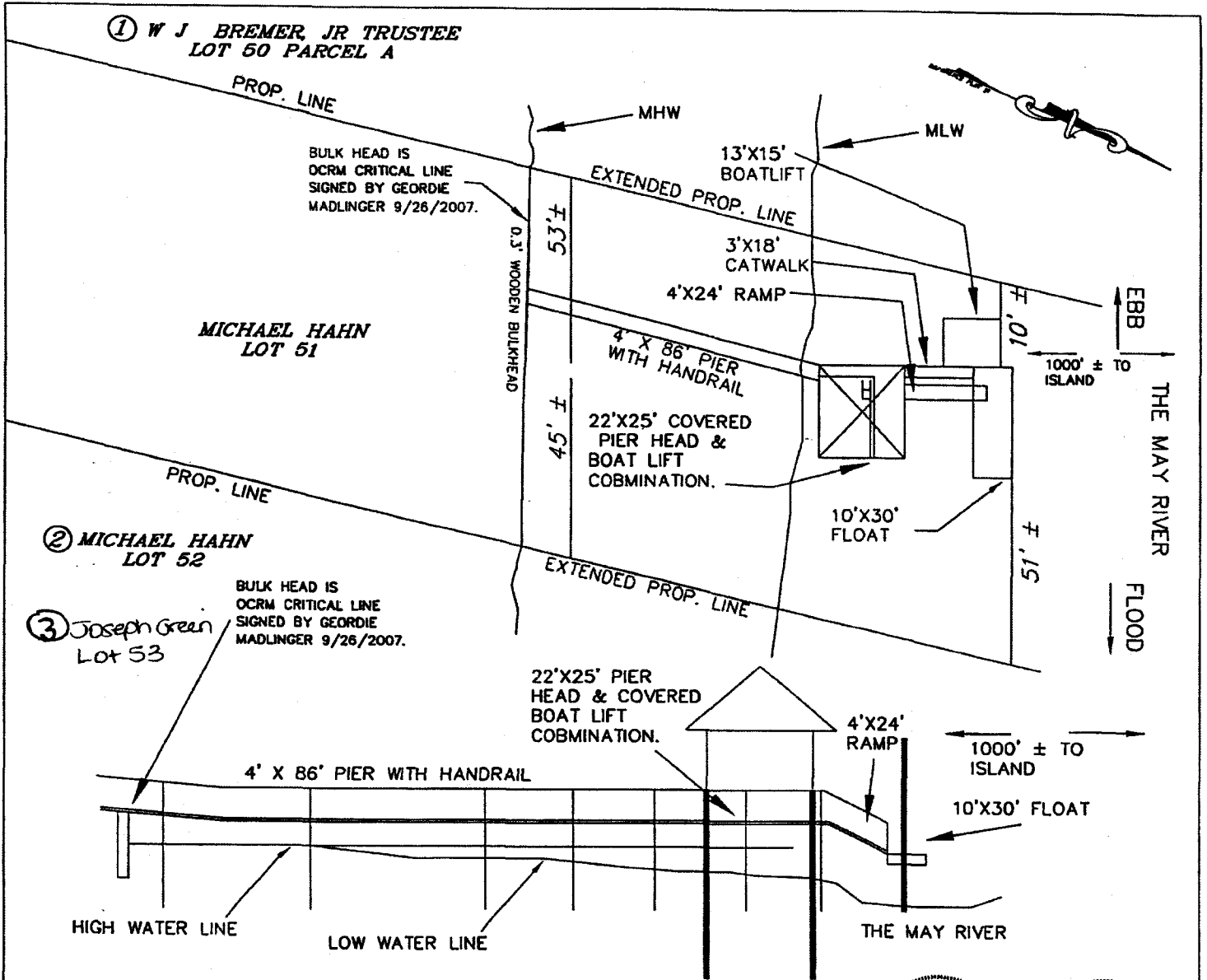

BULK HEAD IS OCRM CRITICAL LINE SIGNED BY GEORDIE MADLINGER 9/26/2007.

BULK HEAD IS OCRM CRITICAL LINE SIGNED BY GEORDIE MADLINGER 9/26/2007.

I HEREBY CERTIFY THAT THE DISTANCES THAT PERTAIN TO CRITICAL LINE AND MARSH LINES ARE CORRECT AND THAT THERE ARE NO ENCROACHMENTS ACROSS EXTENDED PROPERTY LINES

NOT TO SCALE

STATE OF SOUTH CAROLINA
 FOREST F. BAUGHMAN PLS
 50 REGISTERED LAND SURVEYOR # 4922
 PO BOX 336 BLUFFTON, SC 29910

STATE OF SOUTH CAROLINA
 REGISTERED PROFESSIONAL SURVEYOR
 CO0228
 INC.
 STATE OF AUTHORITY

APPLICANT:
MICHAEL HAHN
 ACTIVITY:
PROPOSED DOCK & PIER
 P/N # **OCRM-09-878-L**

LOCATION:
LOT 51 MYRTLE ISLAND LANE
R600-039-00C-0494-0000
 COUNTY: **BEAUFORT**
 DATE: **APRIL 20, 2009**

ADJACENT PROPERTY OWNERS:
 ① **W J BREMER, JR TRUSTEE**
PO BOX 251
BLUFFTON SC, 29910
 ② **MICHAEL HAHN**
65 LAWRENCE STREET
BLUFFTON, SC 29910

③ **Joseph Green**
12 MYRTLE ISL LANE
BLUFFTON SC 29910

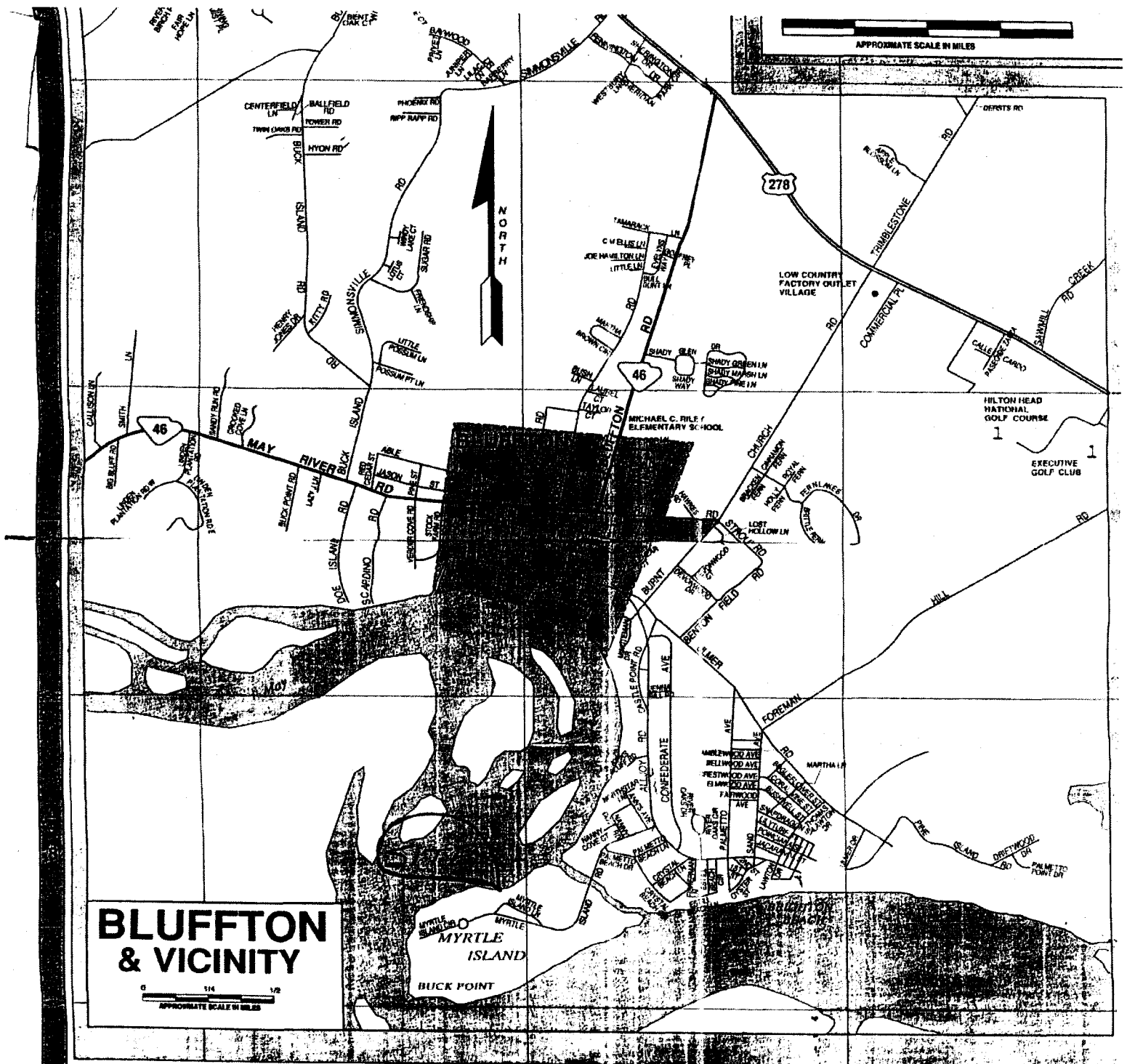

**BLUFFTON
& VICINITY**

0 1/4 1/2
APPROXIMATE SCALE IN MILES

APPLICANT:
MICHAEL HAHN
ACTIVITY:
PROPOSED DOCK & PIER
P/N # **OCRM-09-878-L**

LOCATION:
LOT 51 MYRTLE ISLAND LANE.
R600-039-00C-0494-0000
COUNTY: **BEAUFORT**
DATE: **APRIL 20, 2009**

ADJACENT PROPERTY OWNERS.
① **W J BREMER, JR TRUSTEE**
PO BOX 251
BLUFFTON SC, 29910
② **MICHAEL HAHN**
65 LAWRENCE STREET
BLUFFTON, SC 29910
③ **Joseph Green**
12 Myrtle Isl Lane
Bluffton SC 29910