



C. Earl Hunter, Commissioner

Promoting and protecting the health of the public and the environment.

**PUBLIC NOTICE
AMENDMENT REQUEST**

The permittee for **P/N# OCRM-04-318-R, Alan Cabading**, has requested an amendment to that issued permit. Specifically, the applicant seeks to widen the existing permitted dock walkway from 4' in width to 5' in width. The amendment request is for a private recreational dock on and adjacent to Beresford Creek 1503 Creekside Way, Beresford Creek Landing, Wando, Berkeley County, South Carolina.

Written comments will be received on this amendment request until August 10, 2009 at the address listed below. For further information please contact the project manager, Steve Brooks, 843-953-0200.

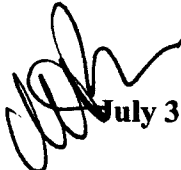
 July 31, 2009

SOUTH CAROLINA DEPARTMENT OF HEALTH AND ENVIRONMENTAL CONTROL

Ocean and Coastal Resource Management

Charleston Office · 1362 McMillan Avenue, Suite 400 · Charleston, SC 29405

Phone: 843-953-0200 · Fax: 843-953-0201 · www.scdhec.gov

CRITICAL LINE IS AS SHOWN
 ON SURVEY DATED JUNE 11, 2009
 SIGNED BY STEVE BROOKS (6-24-09)

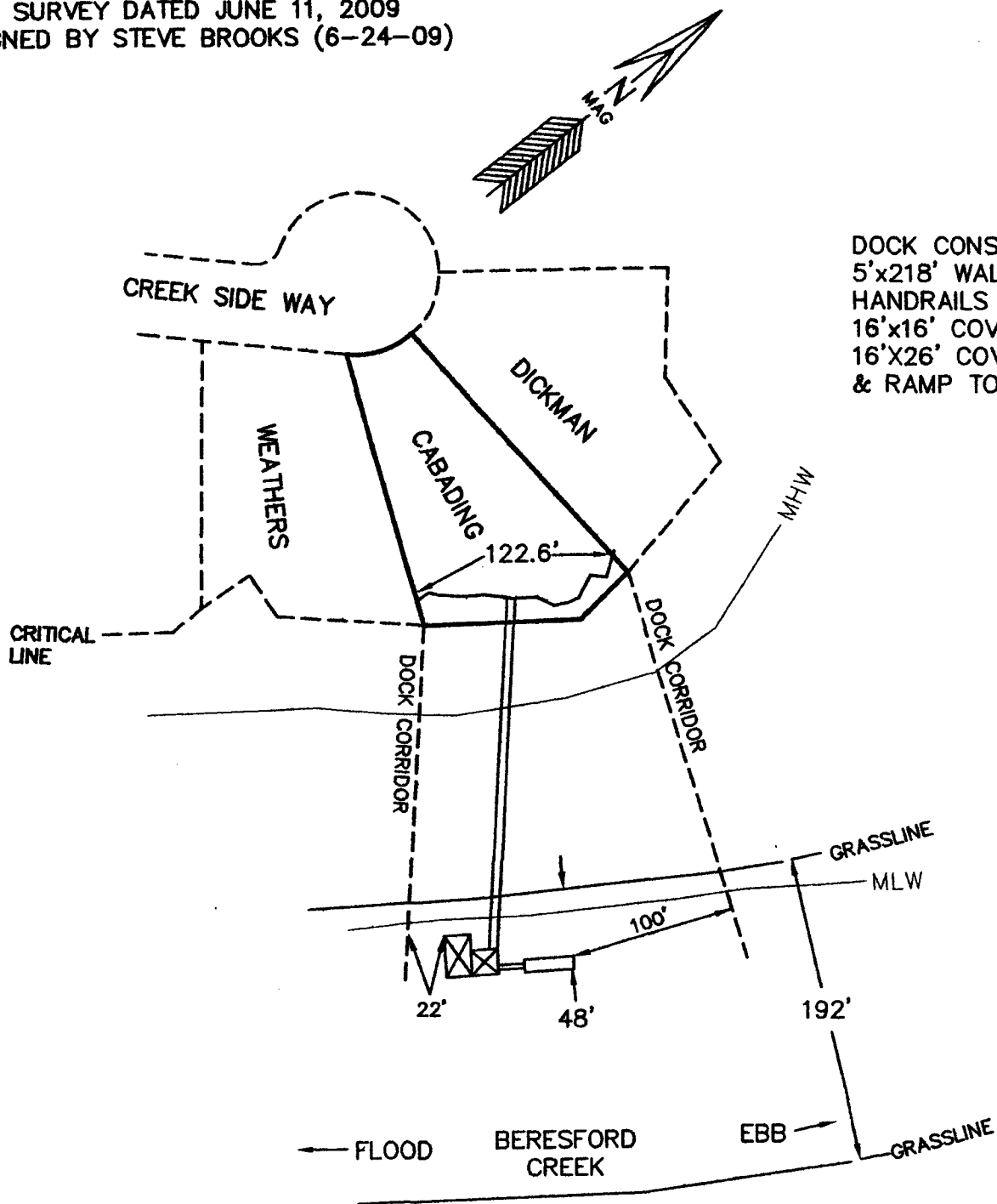

DOCK CONSISTS OF:
 5'x218' WALKWAY WITH
 HANDRAILS
 16'x16' COVERED PIERHEAD
 16'x26' COVERED BOATLIFT
 & RAMP TO 8'x30' FLOAT

APPLICANT: AL CABADING
 1503 CREEK SIDE WAY
 CITY OF CHARLESTON
 BERKELEY COUNTY
 TMS# 271-00-03-083
 BERESFORD CREEK

OCRM-04-318-R

FILE #210-04

PRIVATE
 RECREATIONAL
 DOCK

DATE: MARCH 25, 2009
 SCALE: 1" = 100'



100 0 100

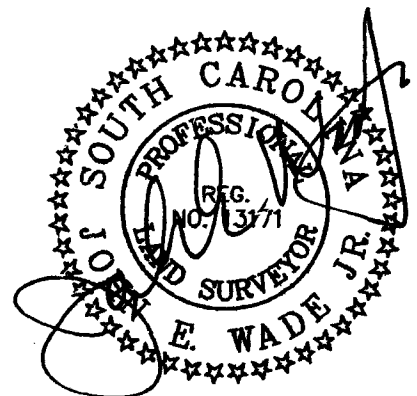

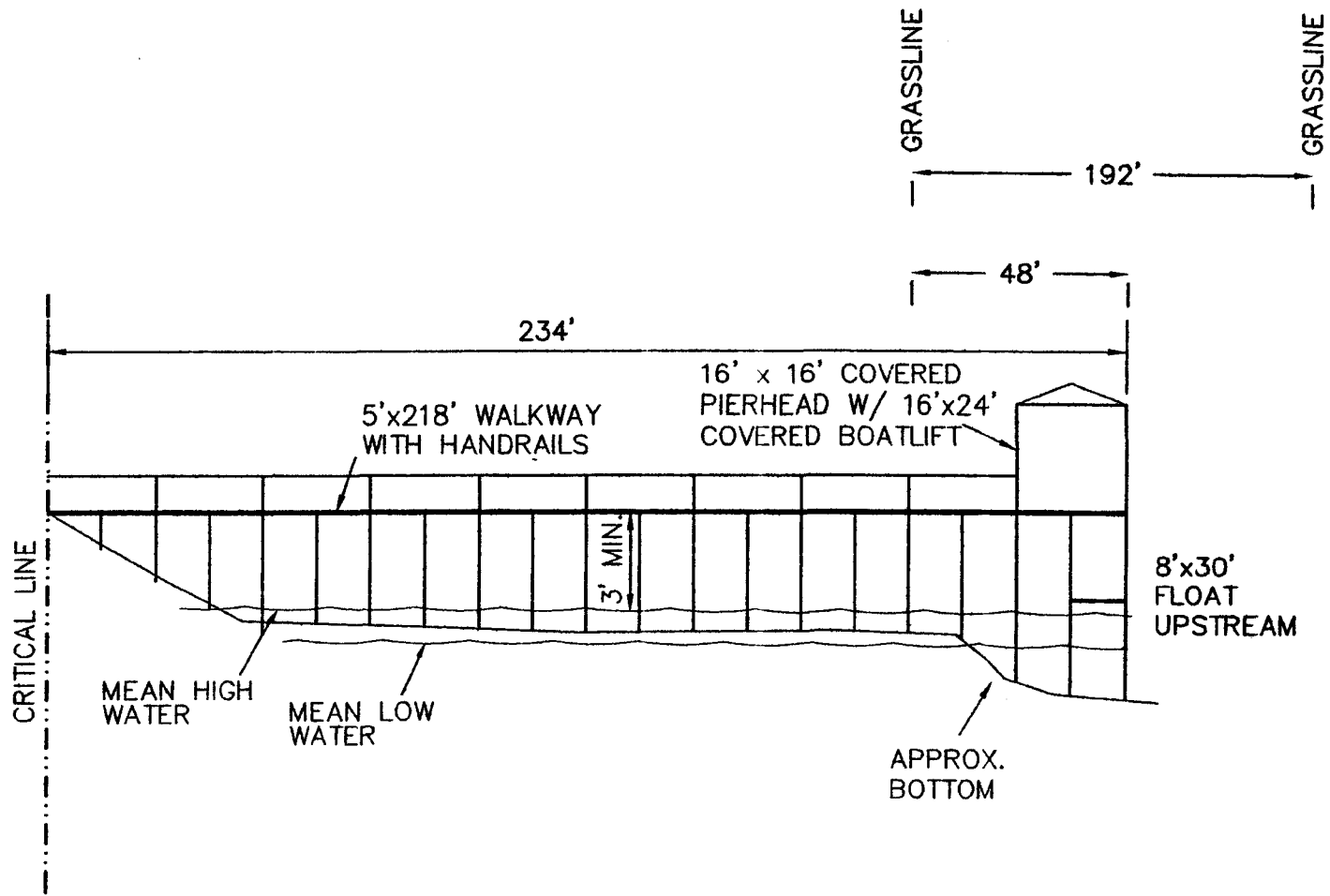

APPLICANT: AL CABADING
 1503 CREEK SIDE WAY
 CITY OF CHARLESTON
 BERKELEY COUNTY
 TMS# 271-00-03-083
 BERESFORD CREEK

OCRM-04-318-R

FILE #210-04

PRIVATE
 RECREATIONAL
 DOCK

DATE: MARCH 25, 2009

NO SCALE

