

**SCDHEC OFFICE OF OCEAN AND COASTAL RESOURCE MANAGEMENT
PERMIT APPLICATION PUBLIC NOTICE**

August 21, 2009

Permit Number: OCRM-09-536-A
Permit ID: 67623

The SCDHEC Office of Ocean and Coastal Resource Management has received an application for a permit for the alteration of a critical area. This application was submitted pursuant to the Coastal Zone Management Act (Act 123) of the 1977 South Carolina General Assembly. The application, in brief, is described as follows:

APPLICANT: Harold Wiegel
c/o Dr. H. Wayne Beam
PO Box 11863
Columbia SC 29211

LOCATION: On and adjacent to Atlantic Intracoastal Waterway at Lot 386 & 387 S Island Dr, North Myrtle Beach, Horry County, South Carolina.
TMS#: 131-31-01-010.

WORK: The work, as proposed and shown on the attached plans consists of constructing two floating docks and boatlift. From the existing walkway, the applicant seeks to build a 4' x 24' walkway to access a 20' x 20' floating dock. From the 4' x 24' walkway, a 3' x 25' access ramp leading to an 8' x 16' floating dock is proposed. The applicant also seeks to build a 12' x 14' boatlift ebb side of the proposed floating docks. The purpose of the proposed activity is for the applicant's private recreational use.

This public notice is being distributed to all known interested persons and agencies to assist in developing facts on which a decision by OCRM can be based. Comments concerning the proposed work should be submitted in writing, setting forth sufficient detail to furnish a clear understanding of the reasons for support or opposition.

The decision to issue or deny a permit will be based on the individual merits of the application, the policies specified in the South Carolina Coastal Zone Management Act, and the considerations outlined in the State of South Carolina Coastal Zone Management Program. Interested parties who wish to be notified of final permit action must notify OCRM in writing of this request.

To assure review by OCRM, comments regarding this application must be received by OCRM on or before September 5, 2009. For further information please contact the project manager for this activity, Tanitra S. Marshall at 843-238-4528.

PLEASE REPLY TO:

SCDHEC OFFICE OF OCEAN AND COASTAL RESOURCE MANAGEMENT
927 Shine Avenue
Myrtle Beach, South Carolina 29577

Please refer to P/N# OCRM-09-536-A

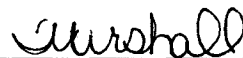

Tanitra S. Marshall, Project Manager

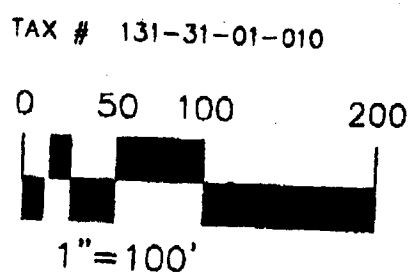
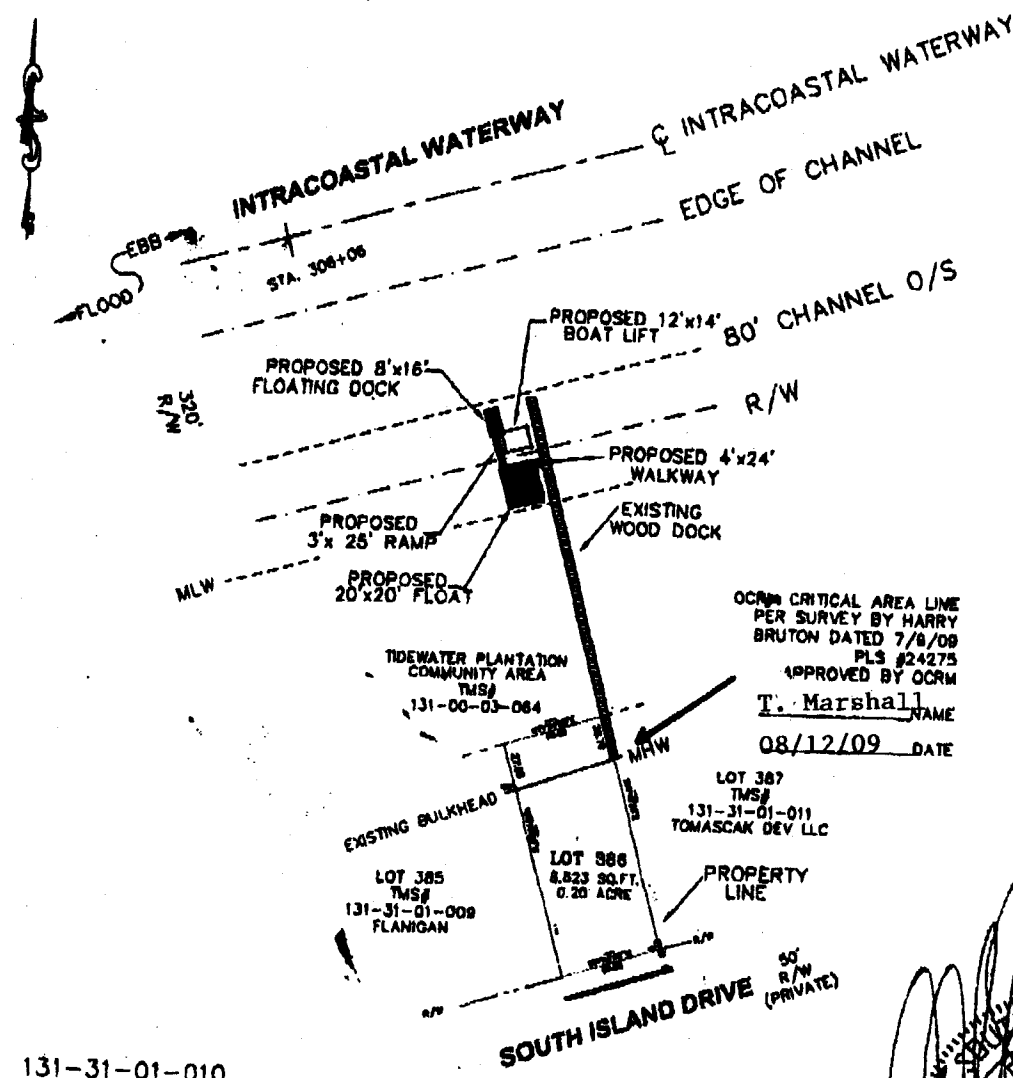

OVERALL SITE PLAN
1"=100'

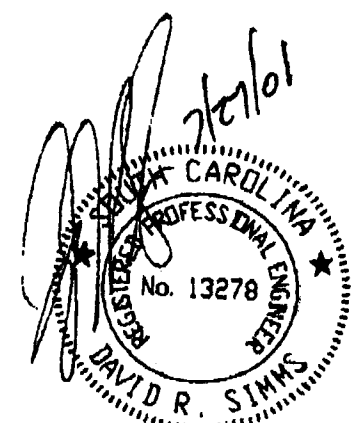

FOR PERMITTING ONLY
NOT FOR CONSTRUCTION

<p>APPLICANT: HAROLD W. & CAROL A. WIEGEL</p> <p>ACTIVITY: Add Boat Lift, Walkway, Ramp & Floats to Exist. Dock</p> <p>P/N# OCRM-09-528-A</p>	<p>LOCATION: Tidewater Plantation</p> <p>INTRACOASTAL WATERWAY</p> <p>COUNTY: Horry</p> <p>DATE: 7/24/2009</p>	<p>SHEET 2 OF 5</p>
---	--	---------------------



INTRACOASTAL WATERWAY

STA. 3084+06

INTRACOASTAL WATERWAY

EDGE OF CHANNEL

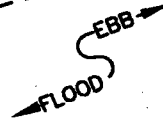

NAD 83 STATE PLANE COORDINATES

80' CHANNEL O/S

320' R/W

N 745598.37
E 2718878.16
N 745596.33
E 2718870.42
N 745604.3979
E 2718894.1630

N 745605.5424
E 2718898.9717

PROPOSED FLOATS
LIFT, RAMP AND WALKWAY

EXISTING
WOOD DOCK

MLW

TIDEWATER PLANTATION
COMMUNITY AREA
TMS#
131-00-03-064

DETAIL
SITE PLAN

1" = 40'

GRAPHIC SCALE

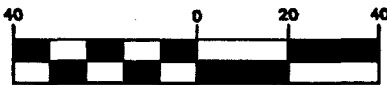

(IN FEET)

1 inch = 40 ft.

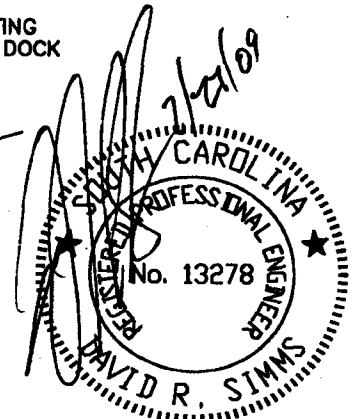

FOR PERMITTING ONLY
NOT FOR CONSTRUCTION

APPLICANT:
HAROLD W. & CAROL A. WIEGEL
ACTIVITY: Add Boat Lift,
Walkway, Ramp &
Floats to Exist. Dock

P/N# OORU-09-536-A

LOCATION:

INTRACOASTAL WATERWAY

COUNTY: Horry

DATE: 7/24/2009

SHEET 3 OF 5

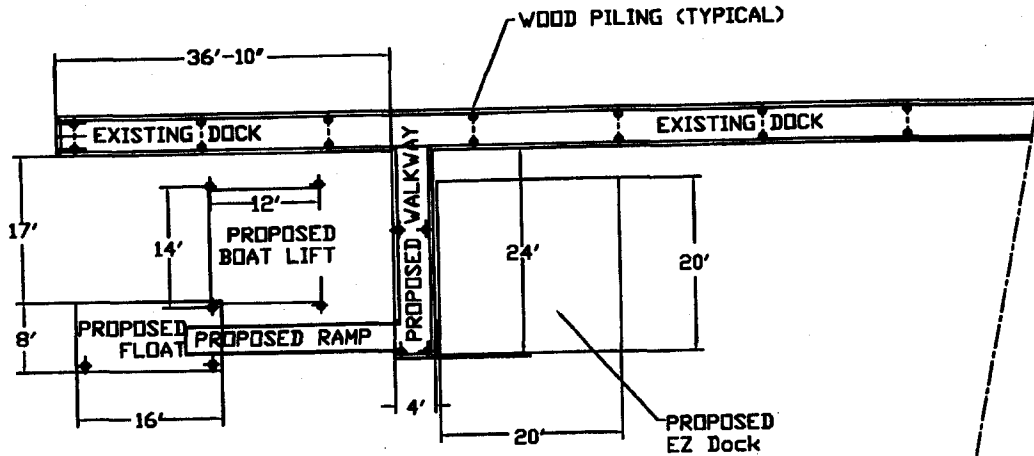

LAYOUT

NTS

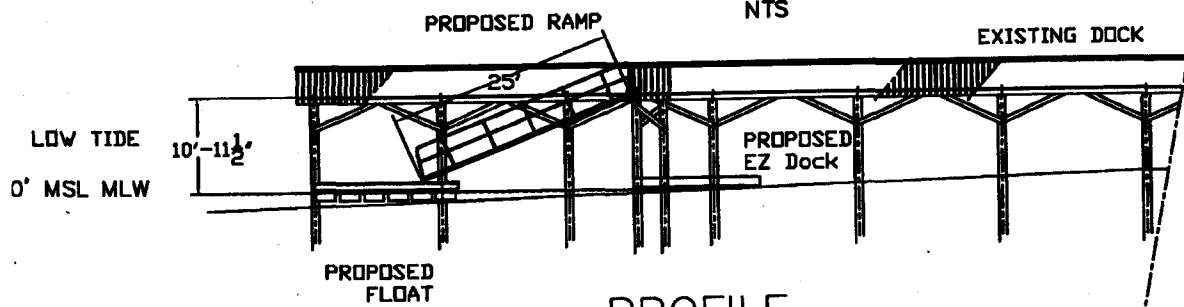

PROFILE

NTS

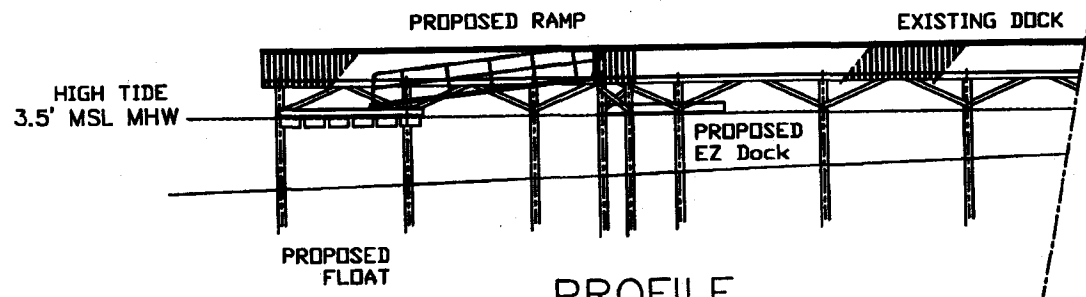

PROFILE

NTS

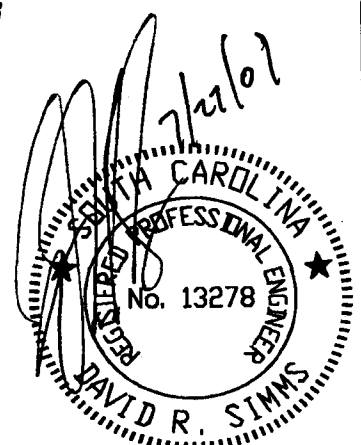

FOR PERMITTING ONLY
NOT FOR CONSTRUCTION

<p>APPLICANT: HAROLD W. & CAROL A. WIEGEL</p> <p>ACTIVITY: Add Boat Lift, Walkway, Ramp & Floats to Exist. Dock</p> <p>P/N# <i>OCRU-09-536-A</i></p>	<p>LOCATION: Tidewater Plantation</p> <p>INTRACOASTAL WATERWAY</p> <p>COUNTY: Horry</p> <p>DATE: 7/24/2009</p>	<p>SHEET 4 OF 5</p>
--	--	---------------------

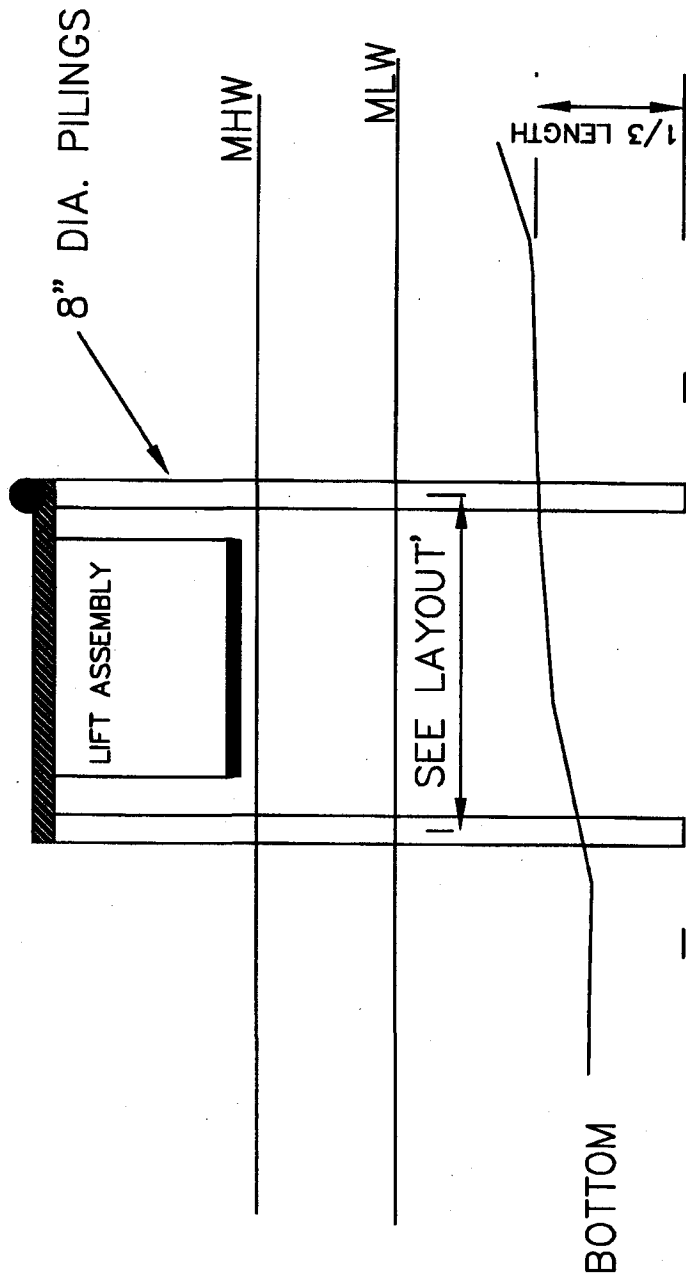

7/27/09
 DAVID R. SWINSON
 REGISTERED PROFESSIONAL ENGINEER
 No. 13278
 NORTH CAROLINA

FOR PERMITTING ONLY
NOT FOR CONSTRUCTION

SECTION - BOAT LIFT

NTS

<p> APPLICANT: HAROLD W. & CAROL A. WIEGEL ACTIVITY: Add Boat Lift, Walkway, Ramp & Floats to Exist. Dock P/N# OADM-09-536-A </p>	<p> LOCATION: TIDEWATER PLANTATION Little River Township COUNTY: Horry DATE: 7/24/2009 </p>	<p>SHEET 5 of 5</p>
--	--	---------------------

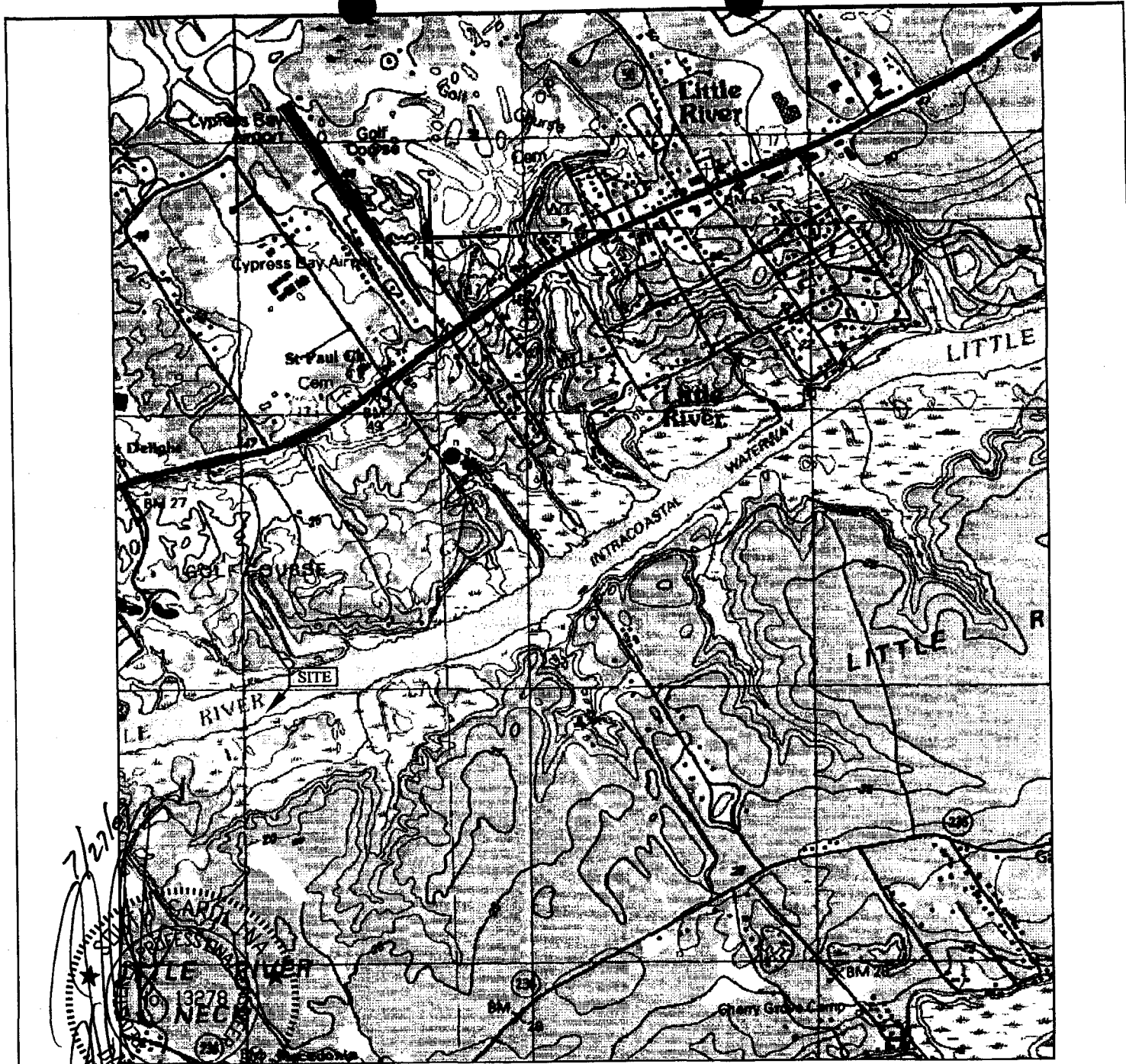

SITE LOCATION PLAN

USGS LITTLE RIVER QUAD

FOR PERMITTING ONLY
NOT FOR CONSTRUCTION

APPLICANT:
HAROLD W. & CAROL A. WIEGEL
ACTIVITY: Add Boat Lift,
Walkway, Ramp &
Floats to Exist. Dock

P/N# OCRM-09-536-A

LOCATION: Tidewater Plantation

INTRACOASTAL WATERWAY

COUNTY: Horry

DATE: 7/24/2009

SHEET 1 OF 5