



C. Earl Hunter, Commissioner

Promoting and protecting the health of the public and the environment.

**PUBLIC NOTICE
AMENDMENT REQUEST**

The permittee for P/N# **OCRM-09-002-M, Eleanor C. Rice**, has requested an amendment to that issued permit. Specifically, the applicant proposes to install an additional 8' by 14' jet float ebbside of the previously permitted 10' by 16' floating dock. The proposed amendment is for modifications to a private recreational use dock on and adjacent to Store Creek at 8242 Peters Point Road, Edisto Island, Charleston County, South Carolina.

Written comments will be received on this amendment request until October 12, 2009 at the address listed below. For further information please contact the project manager, Fred Mallett, at 843-953-0236.

 October 02, 2009

SOUTH CAROLINA DEPARTMENT OF HEALTH AND ENVIRONMENTAL CONTROL

Ocean and Coastal Resource Management

Charleston Office • 1362 McMillan Avenue, Suite 400 • Charleston, SC 29405

Phone: 843-953-0200 • Fax: 843-953-0201 • www.scdhec.gov

NOTE:
 DHEC/OCRM CRITICAL LINE IS THE SAME AS SHOWN ON A PLAT BY R.J. GRICE SURVEYING DATED 11-24-08 WITH A CRITICAL LINE CERTIFICATION BY FRED MALLET DATED 12-08-08.

OCRM CRITICAL LINE / TOP OF BLUFF
 ELEVATION = 10.0'±

ELEVATION AT TOP OF BULKHEAD (EL = 7.6'±) TO BE 4' ABOVE MHW

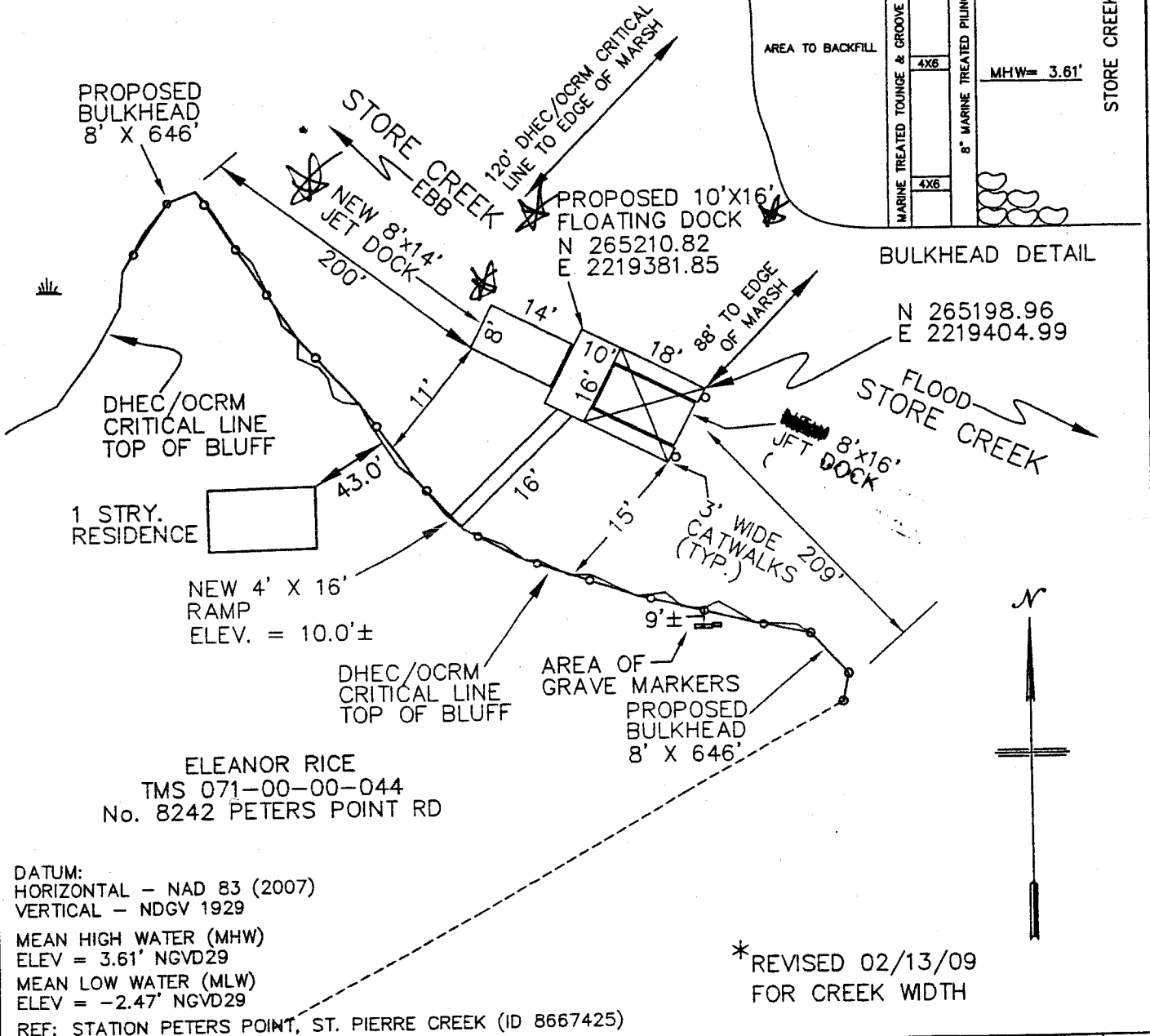

N 265198.96
 E 2219404.99



*REVISED 02/13/09
 FOR CREEK WIDTH

DATUM:
 HORIZONTAL - NAD 83 (2007)
 VERTICAL - NDGV 1929

MEAN HIGH WATER (MHW)
 ELEV = 3.61' NGVD29
 MEAN LOW WATER (MLW)
 ELEV = -2.47' NGVD29

REF: STATION PETERS POINT, ST. PIERRE CREEK (ID 8667425)

APPLICANT: ELEANOR RICE
 LOCATION:
 No. 8242 PETERS POINT RD.
 EDISTO ISLAND, S.C. 29438
 TMS 071-00-00-044
 COUNTY: CHARLESTON
 WATERWAY: STORE CREEK

PROPOSED DOCK & BULKHEAD
 PLAN VIEW
 NOVEMBER 25 2008
 REVISED: 09-05-09
 NOT TO SCALE
 PAGE 3 OF 3 08-0016

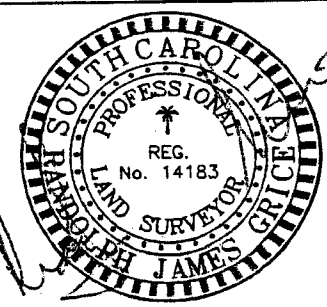

09/15/09

OCRM-09-002-M
 AMENDMENT

No Roof

NOTE:
 DHEC/OCRM CRITICAL LINE IS THE SAME AS
 SHOWN ON A PLAT BY R.J. GRICE SURVEYING
 DATED 11-24-08 WITH A CRITICAL LINE
 CERTIFICATION BY FRED MALLET DATED 12-08-08.

OCRM CRITICAL LINE /
 TOP OF BLUFF
 ELEVATION = 10.0'±

ELEVATION AT
 TOP OF BULKHEAD
 (EL. = 7.6'±) TO BE 4' ABOVE MHW

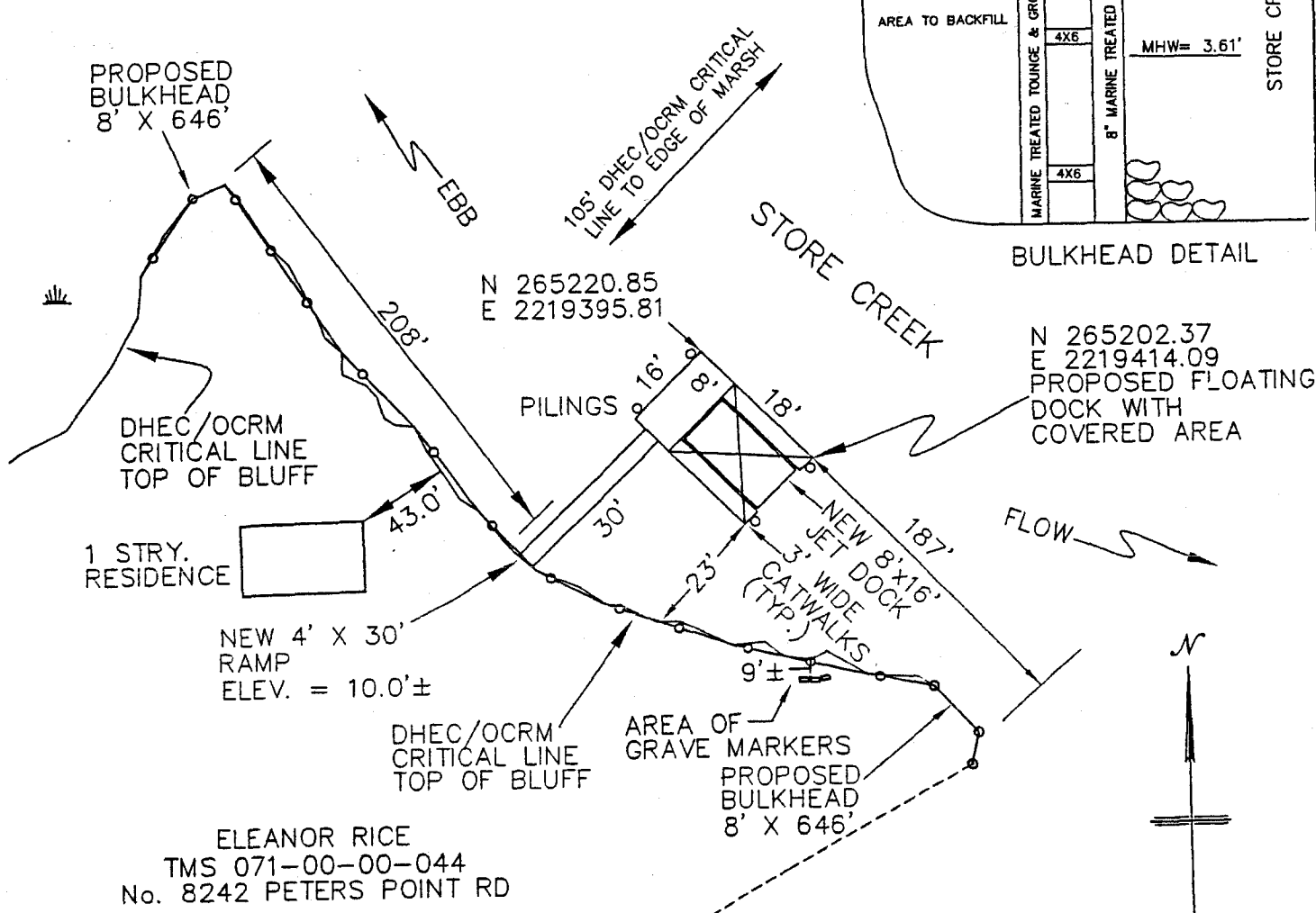

ELEANOR RICE
 TMS 071-00-00-044
 No. 8242 PETERS POINT RD

DATUM:
 HORIZONTAL - NAD 83 (2007)
 VERTICAL - NAD 83 (2007)
 MEAN HIGH WATER (MHW)
 ELEV = 3.61' NGVD29
 MEAN LOW WATER (MLW)
 ELEV = -2.47' NGVD29
 REF: STATION PETERS POINT, ST. PIERRE CREEK (ID 8667425)

APPLICANT: ELEANOR RICE LOCATION: No. 8242 PETERS POINT RD. EDISTO ISLAND, S.C. 29438 TMS 071-00-00-044 COUNTY: CHARLESTON WATERWAY: STORE CREEK	PROPOSED DOCK & BULKHEAD PLAN VIEW NOVEMBER 25 2008 NOT TO SCALE PAGE 3 OF 3 08-0016	<p style="text-align: right; font-size: 2em;">01-12-09</p>
--	--	--

OCRM-09-002-M AS PERMITTED No Roof