

**SCDHEC OFFICE OF OCEAN AND COASTAL RESOURCE MANAGEMENT  
PERMIT APPLICATION PUBLIC NOTICE**

**October 23, 2009**

**Permit Number:** OCRM-09-828-G  
**Permit ID:** 66233

The SCDHEC Office of Ocean and Coastal Resource Management has received an application for a permit for the alteration of a critical area. This application was submitted pursuant to the Coastal Zone Management Act (Act 123) of the 1977 South Carolina General Assembly. The application, in brief, is described as follows:

**APPLICANT:** Donald Boozer  
C/o Gasque & Associates, Inc.  
28 Professional Village Circle  
Lady's Island, SC 29907

**LOCATION:** On and adjacent to Coosaw River at 43 Sandpiper Lane, Coosaw Island, Beaufort County, South Carolina.  
TMS#: R200-007-000-0138-0000.

**WORK:** The work, as proposed and shown on the attached plans, consists of constructing a private dock. Specifically, the structure will have a 4'x778.05' walkway with handrails leading to a 15'x15' covered fixed pierhead with water and electricity. On the ebb-side of the pierhead a 4'x30' ramp will lead to a 12'x20' floating dock. On the flood-side of the pierhead a 3'x30' catwalk will lead to 12'x12' four pile boatlifts, one on each side of the catwalk. Additionally, a mooring bouy will be placed on the flood-side of the proposed boatlifts. The purpose of the dock is for the applicant's private, recreational use.

This public notice is being distributed to all known interested persons and agencies to assist in developing facts on which a decision by OCRM can be based. Comments concerning the proposed work should be submitted in writing, setting forth sufficient detail to furnish a clear understanding of the reasons for support or opposition.

The decision to issue or deny a permit will be based on the individual merits of the application, the policies specified in the South Carolina Coastal Zone Management Act, and the considerations outlined in the State of South Carolina Coastal Zone Management Program. Interested parties who wish to be notified of final permit action must notify OCRM in writing of this request.

*To assure review by OCRM, comments regarding this application must be received by OCRM on or before November 7, 2009. For further information please contact the project manager for this activity, Geordie Madlinger at 843-846-9400.*

**PLEASE REPLY TO:**

SCDHEC OFFICE OF OCEAN AND COASTAL RESOURCE MANAGEMENT  
104 Parker Drive  
Beaufort, South Carolina 29906

**Please refer to P/N# OCRM-09-828-G**

  
\_\_\_\_\_  
George J Madlinger, Senior Wetland Project Manager



OCRM-09-828-G

SHEET # 1 OF 3

**GASQUE & ASSOCIATES INC.**  
**LAND SURVEYORS & PLANNERS**  
 28 PROFESSIONAL VILLAGE CIRCLE, BEAUFORT, S.C.  
 P.O. BOX 1363, BEAUFORT, S.C.  
 PHONE (843) 522-1788

PROPOSED  
 12'X20'  
 FLOAT  
 4'x20' RAMP

OCRM DHEC CRITICAL LINE  
 GEORDIE MADLINGER (OCRM)  
 DATE 2.18.09

PROPOSED WALKWAY  
 WITH HANDRAILS  
 TOTAL LENGTH: 778.05

SURVEYOR SIGNED HEREON IS CHARGED WITH SURVEY  
 MATTERS AND THE PHYSICAL DRAWING ON A COMPUTER  
 DRAFTING SYSTEM ONLY. THIS IS NOT A DESIGN OR  
 INTENDED TO BE ONE. ALL DEFLECTIONS THAT ARE NOT  
 SURVEY MATTERS IS PROVIDED BY OTHERS.

*[Signature]* 10.12.09

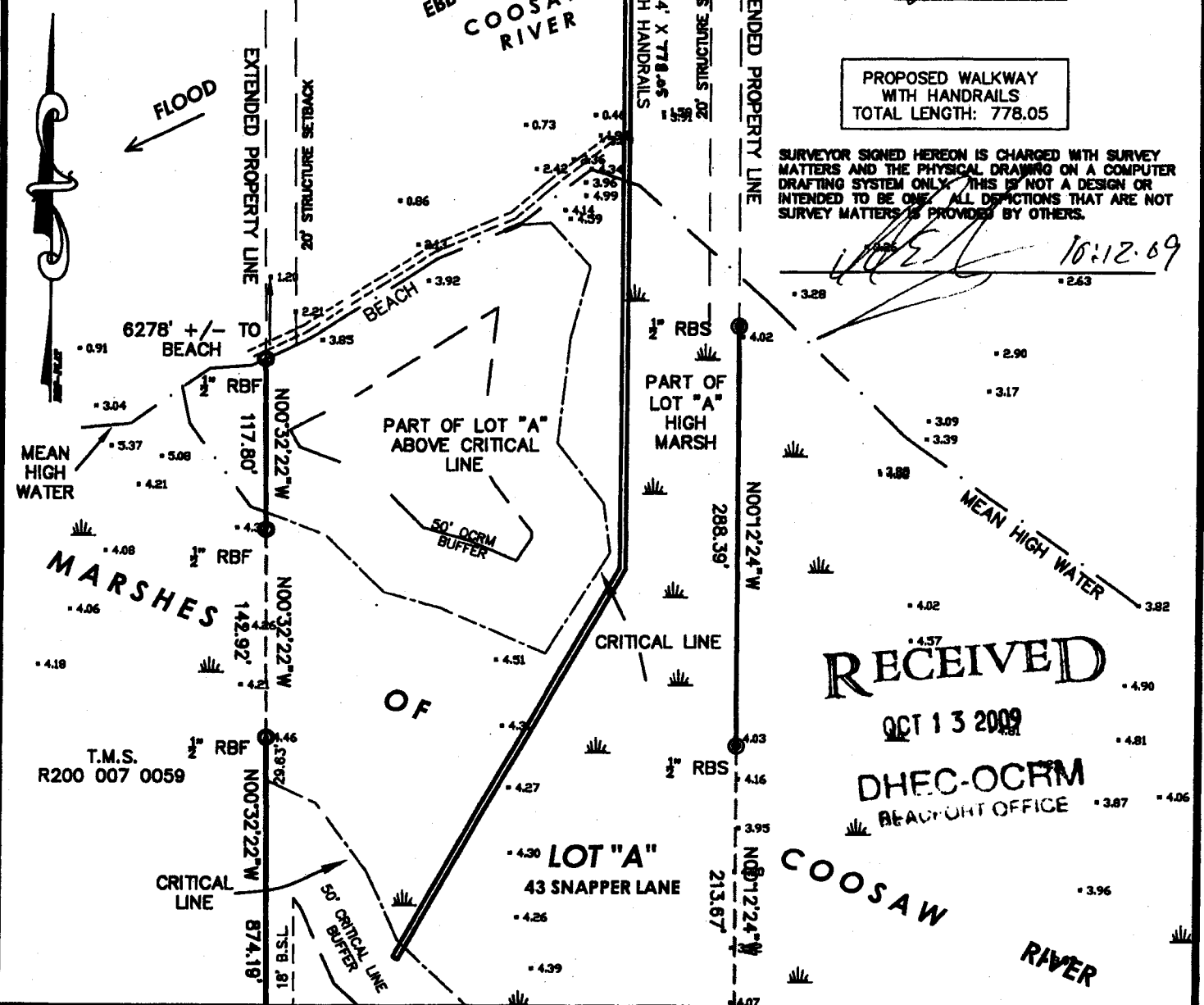

ADJACENT PROPERTY OWNERS:  
 1. MILLER INVESTMENT PROP LLC  
 18355 KALABASH RD  
 CHARLOTTE, NC 28278  
 LOT 2 PARCEL B-1  
 R200 007 0135  
 2. H.B. JR & DOROTHY L. ATTAWAY  
 PO BOX 2009  
 BEAUFORT, SC 29901  
 R200 007 0059

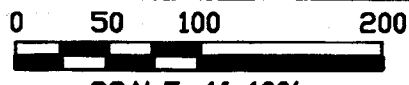

SCALE: 1"=100'  
 DONALD BOOZER  
 18728 CORRADALE RD  
 CHARLOTTE, NC 28278  
 R200 007 0138  
 LOT "A"  
 43 SNAPPER LANE

PROPOSED PRIVATE DOCK  
 IN: COOSAW RIVER  
 AT: COOSAW ISLAND  
 COUNTY OF: BEAUFORT  
 STATE: SOUTH CAROLINA  
 JOB# 35563 FB RBP/644 DSGN5 DATE: 9/28/09

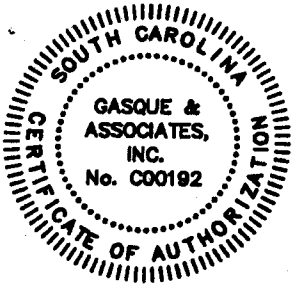

**GASQUE & ASSOCIATES INC.**  
**LAND SURVEYORS & PLANNERS**

28 PROFESSIONAL VILLAGE CIRCLE, BEAUFORT, S.C.  
 P.O. BOX 1363, BEAUFORT, S.C.  
 PHONE (843) 522-1198

SHEET # 2 OF 3

**PLAN VIEW**

**COOSAW RIVER**

EXTENDED PROPERTY LINE

PROPOSED  
 15'X15'  
 COVERED  
 PIERHEAD

20.0'

PROPOSED  
 12'X20'  
 FLOAT

4'X30' RAMP

PROPOSED  
 3'X30' CATWALK

2 PROPOSED  
 12'X12' BOATLIFTS

PROPOSED WALKWAY WITH HANDRAILS  
 TOTAL LENGTH: 778.05

OCRM DHEC CRITICAL LINE  
 GEORDIE MADLINGER (OCRM)  
 DATE 2-18-09

PROPOSED  
 MOORING BOUY

6278' +/- TO BEACH

1" RBF

EXTENDED PROPERTY LINE

NOT TO SCALE

T.M.S.  
 R200 007 0059

**PROFILE VIEW**

RECEIVED

00115.09

DHEC-OCRM  
 BEAUFORT OFFICE

PROPOSED  
 15'X15'  
 COVERED  
 PIERHEAD

2 PROPOSED  
 12'X12'  
 BOATLIFT

3'X30' CATWALK

PROPOSED WALKWAY WITH HANDRAILS  
 TOTAL LENGTH: 778.05

PROPOSED  
 4'X30'  
 RAMP

PROPOSED  
 12'X20'  
 FLOAT

APPROX. MEAN HIGH WATER  
 APPROX. MEAN LOW WATER

BEACH

PART OF LOT "A"  
 ABOVE CRITICAL LINE

OCRM DHEC CRITICAL LINE  
 GEORDIE MADLINGER (OCRM)  
 DATE 2-18-09

137+/-

189+/-

OCRM DHEC CRITICAL LINE  
 GEORDIE MADLINGER (OCRM)  
 DATE 2-18-09

6278' +/- TO BEACH

10.12.09

SURVEYOR SIGNED HEREON IS CHARGED WITH SURVEY MATTERS AND THE PHYSICAL DRAWING ON A COMPUTER DRAFTING SYSTEM ONLY. THIS IS NOT A DESIGN OR INTENDED TO BE ONE. ALL DEPICTIONS THAT ARE NOT SURVEY MATTERS IS PROVIDED BY OTHERS.

NOT TO SCALE

**ADJACENT PROPERTY OWNERS:**

- MILLER INVESTMENT PROP LLC  
 18355 KALABASH RD  
 CHARLOTTE, NC 28278  
 LOT 2 PARCEL B-1  
 R200 007 0135
- H.B. JR & DOROTHY L. ATTAWAY  
 PO BOX 2009  
 BEAUFORT, SC 29901  
 R200 007 0059

OCRM-09-828-G

DONALD BOOZER  
 18728 CORRADALE RD  
 CHARLOTTE, NC 28278  
 R200 007 0138  
 LOT "A"  
 43 SNAPPER LANE

**PROPOSED PRIVATE DOCK**

IN: COOSAW RIVER  
 AT: COOSAW ISLAND

COUNTY OF: BEAUFORT  
 STATE: SOUTH CAROLINA

JOB# 35563 FB RBP/644 DSGN5 DATE: 9/28/09



**GASQUE & ASSOCIATES INC.  
LAND SURVEYORS & PLANNERS**

28 PROFESSIONAL VILLAGE CIRCLE, BEAUFORT, S.C.  
P.O. BOX 1363, BEAUFORT, S.C.  
PHONE (843) 522-1798

RECEIVED  
10/12/09  
GASQUE & ASSOCIATES  
SURVEY OFFICE

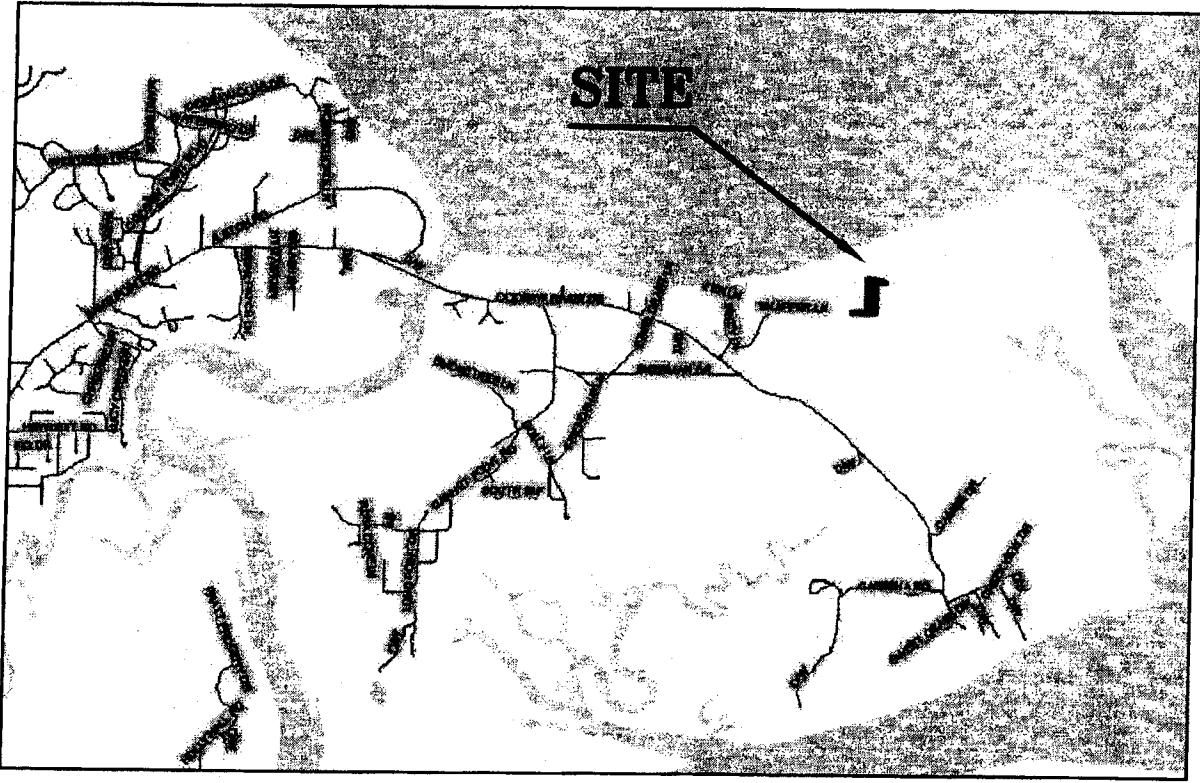

NOT TO SCALE

SURVEYOR SIGNED HEREON IS CHARGED WITH SURVEY MATTERS AND THE PHYSICAL DRAWING ON A COMPUTER DRAFTING SYSTEM ONLY. THIS IS NOT A DESIGN OR INTENDED TO BE ONE. ALL DEPICTIONS THAT ARE NOT SURVEY MATTERS IS PROVIDED BY OTHERS.

*[Signature]* 10/12/09

ADJACENT PROPERTY OWNERS:  
1. MILLER INVESTMENT PROP LLC  
18355 KALABASH RD  
CHARLOTTE, NC 28278  
LOT 2 PARCEL B-1  
R200 007 0135  
2. H.B. JR & DOROTHY L. ATTAWAY  
PO BOX 2009  
BEAUFORT, SC 29901  
R200 007 0059

OCRM-09-828-G  
DONALD BOOZER  
18728 CORRADALE RD  
CHARLOTTE, NC 28278  
R200 007 0138  
LOT "A"  
43 SNAPPER LANE

PROPOSED PRIVATE DOCK  
IN: COOSAW RIVER  
AT: COOSAW ISLAND  
COUNTY OF: BEAUFORT  
STATE: SOUTH CAROLINA  
JOB# 35563 FB RBP/844 DSCN5 DATE: 9/28/09